

Your one truly LOCAL
Community Magazine,
delivered FREE
to every home



Keep Me
I'm useful

Winterbourne & Frampton

including Coalpit Heath & Winterbourne Down

Matters

Nov 2016



aj homes

Your Local Agent for
Sales, Lettings & Management

01454 252 140
email: info@aj-homes.co.uk
www.aj-homes.co.uk

A Business Based On -
TRUST, HONESTY & PROFESSIONALISM

**FIND YOUR
PERFECT SPOT**

...with MacKendrick Norcott this Autumn

MacKendrick Norcott

01454 77 24 68 SALES

01454 85 11 11 LETTINGS

office@mnteam.co.uk

www.mackendrick-norcott.co.uk





SGS COLLEGE OPEN TO ALL!

Join us at our next Open Event on
Saturday 5 November 10am - 2pm

Join us for our Open Events at **SGS Filton, SGS Wise and SGS Queens Road Campuses** and find out about our wide range of apprenticeships, full and part-time study programmes and University Level courses including:

- Access to University
- Apprenticeships
- Employability courses
- Full time GCSEs & A Levels
- Full time vocational courses in Animal Care, Art & Design, Business, Construction, Early Years, Engineering, Hair & Beauty, Health & Social Care, IT, Media & Games Design, Music, Performing Arts, Public Services, Sport & Exercise, Travel & Tourism

- Speak with course specialists
- Meet with current learners studying at SGS College
- Try out activities relating to your subject of interest



For further details visit www.sgscol.ac.uk
or call 0800 0567 253



OFSTED OUTSTANDING

For Business, Art, Performing Arts, Sports, Employability, Student Support and Leadership and Management of the College.



Dear Residents,



Welcome to the November issue, as we write this the trees are turning golden and it is feeling decidedly

Autumnal, our local countryside is looking beautiful.

Many of you enjoyed the recent Orchard Harvest Day at Winterbourne Medieval Barn. We were blessed with glorious weather - as you can tell by the front cover. You can see further photos within the magazine, along with details of their next big event - Carols in the Barn.

There are numerous festive fairs, musical shows and activities taking place over the next two months, find out more throughout the magazine.

Share in the fun and excitement of Year 6 pupils from St Michael's Primary School, as we

print news of their recent adventure to Morfa Bay, South Wales.

We were pleased to be contacted by Frampton Cotterell and Coalpit Heath Branch of the Royal British Legion this month, although it was with the sad news that the last of their branch members to have served in the 1939 - 1945 conflict has now passed away. We are pleased to pay tribute to Mr Royston Fudge. You will also find details of the local Remembrance Day services in this article.

We bring you news of a lovely nature walk at Says Court Solar Farm that would make a perfect Autumnal activity.

There are reports from all your favourite local groups and plenty of ideas for activities to take part in.

Enjoy the fireworks at Sunnyacres Farm!



Kerry & Jaci x

community@mattersmagazines.co.uk 01454 300900

Bundy & Bond
Independent Estate Agents
01454 540 200
www.bundyandbond.co.uk
Email: info@bundyandbond.co.uk

Mary Bond and Tina Bundy

Offering high standards of service and excellent customer care

Our aim is to sell your property at the maximum price and with the minimum level of hassle. We will guide, support and advise you throughout the entire sales process.

With more than 33 years experience of selling in the local area, free professional photography used for all our properties, see our 5* google and Facebook reviews



Congratulations Lexi!

Talented local youngster – Lexi Johnson, won the regional title in late September for martial arts, in Sparring category.

The competition took place at Thornbury Leisure Centre. The event drew in competitors Wales and Bournemouth, as well as local areas.

Lexi fought a number of girls her age and belt grade to make her way in to the final!

At time of writing, 12 year old Lexi, who attends Winterbourne Academy, is due to be competing in Manchester, for a chance of the title of world champion! She qualified for the world championships in West Bromwich, taking 2 podium wins for sparring and forms.

She is currently the international champion in Dragon Tang Soo do in which she trains in as her martial art, in Baileys Court Primary school.

We wish Lexi the very best of luck!

Coalpit Heath

Pre-School

New premises: Mafeking Hall
Serridge Lane
Coalpit Heath

We provide a happy, stimulating and caring environment for children aged 2-5yrs.
Rated "Outstanding" by Ofsted.

Our NVQ trained staff are committed to delivering the highest quality of learning and care.
Government funded places available.

- Breakfast club featuring mini me munchies (Lunchtime meals coming soon) ✓
- Exciting outdoor area - Forest School Sessions ✓
- Secure premises with sole use ✓
- Open 8am – 3pm Monday to Friday ✓

To book your place please call:
07715 531066
E-mail: coalpitheathpreschool@outlook.com

Morfa Bay Adventures

What a start our Year 6 had to the year – a five day residential in South Wales! It was an action packed week, filled with lots of fun activities.

Before we left Winterbourne, the bus was buzzing with excitement and the first of the sweets had already been opened! On arrival at Morfa Bay camp we were whisked straight off to squeeze into our wetsuits for the first activity – boobyboarding at Pendine Sands. I have never seen so many children (and adults) so happy to be in the water at once, splashing about and trying to catch the ultimate wave. Our first evening was spent 'hiking up and down dale' with the intention of wearing the children out for their first night away – it worked!

The rest of the week went equally as smoothly with our children participating in all of the activities with courage and vigour. Many of the activities were new to the children and one of the highlights for them must have been the mud assault course during which they rolled around in large muddy puddles, climbed through water filled concrete tubes and tested their balance skills out above large ponds of muddy water amongst numerous other obstacles. Fears of height and small spaces were overcome by many of the children who went climbing, on the high ropes course, the zip wire and caving.

The teamwork that was displayed throughout the week and the care the children had for each other was second to none – they were a real pleasure to take away. We returned with some very tired children, but they created memories that week which will last them a lifetime.

Kirsty Robson

Deputy Head, St Michael's Primary School, Winterbourne



Pregnant? Know someone who is?

Reduced anxiety

+ Improved control

= Positive birth experience

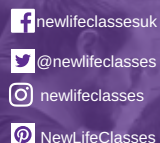

BRISTOL: Bedminster - Bishopston - Bradley Stoke - Clifton - Emersons Green - Nailsea
Portishead - Westbury-on-Trym GLOUCESTER: Abbeydale - Stroud - Quedgeley

www.newlifeclases.com/relaxation-workshop



BOOK your antenatal course using the code RELAX_WM1 by 30th November

FREE
relaxation
techniques
for labour
workshop!





In a relaxed environment, our volunteers will show you how to use a computer (PC, laptop or tablet) for word processing, creating spreadsheets, writing emails and using the internet.

Whether you are a complete beginner or someone who wants to improve their skills, we can help.

We use our own PCs, laptops and tablets but you are welcome to bring your own with you and our volunteer helpers will be happy to help with any questions which you may have resulting from use of your own computer or tablet. With one helper for every 2 students, you will learn through practical exercises with someone always on hand to help if you need it.

The Computer Group meets at the Bickeridge Centre in Frampton Cotterell on Monday to Thursday mornings. Each session lasts for 2 hours and costs just £2.50.

You can attend as many sessions as you like as our courses are designed so that each person can proceed at their own pace. You can join the Computer Group at any time as soon as there is space available on the day you would like to attend.

If you would like to book a place, please contact: Jill Allan on: 01454 864442.



Frampton Cotterell Computer Group

www.fccomputergroup.uk

If you would like to learn how to use your computer or brush up on old skills, we are here to help you with one to one and group sessions. We meet at The Bickeridge Centre, Woodend Road Frampton Cotterell.

Mon - Thurs 9.30am - 11.30am
for each 2 hour session the cost is £2.50

If you would like to join us please call Jill on:
01454 864442



Products and services designed for the over 50s

- Home Insurance
- Travel Insurance
- Funeral Plans
- Car Insurance
- Gas and Electricity*
- Personal Alarms



For a no obligation quote, visit:

Age UK South Gloucestershire
67 High Street, Thornbury BS35 2AW
Tel: 01454 800672

Open: Monday to Friday - 9am till 1pm
or visit www.ageukproducts.com

Buying Age UK Products & Services helps fund our charitable work



Age UK Home, Car and Travel Insurance are provided by Ageas Insurance Limited. Gas and Electricity is provided by E.ON Energy Solutions Limited. The Age UK Funeral Plan is offered by Advance Planning Limited. Age UK Personal Alarms are provided by Aid-Call Limited.

*For people aged 60 and over (or 50-59 if eligible to be registered for priority services).

Age UK Enterprises Limited is the commercial arm of Age UK (charity no.1128267) and donates its net profits to that charity. Age UK Enterprises Limited is registered in England and Wales no.3156159. Registered address: Tavistock House, 1-6 Tavistock Square, London WC1H 9NA.

MP5496V1AUG15 DM009123_16

Lest We Forget

Winterbourne & Frampton Matters was pleased to hear from the Frampton Cotterell and Coalpit Heath Branch of the Royal British Legion this month, although it was with the sad news that the last of their branch members to have served in the 1939 - 1945 conflict has now passed away.

Mr Royston Fudge, late President of Frampton Cotterell and Coalpit Heath Branch of the Royal British Legion, passed away on 9th September 2016, aged 90 years. Roy joined the Royal Navy in 1942 and served with distinction till the end in 1945 on HMS Beagle, HMS Formidable and HMS Hogue. He was in the Battle of the Atlantic escorting vessels carrying supplies to Russia for which he was awarded two medals from the Russian Government - one from President Mikhail Gorbachev and one from President Vladimir Putin. He received an additional medal from the people of the Soviet Union in gratitude for his duties. Roy also served on one of the Ships that liberated the Channel Islands, for which he also received a medal.

Roy was very well known in the village, having lived in Frampton Cotterell for many years. He joined the Frampton Cotterell and Coalpit Heath Branch of the Royal British Legion, (RBL), where he remained a regular for the rest of his life. On speaking to members, Winterbourne Matters has heard that Roy was a young and active man despite his years. Always smiling and fun loving, he particularly loved his dancing; often on the door of the club he loved to get up on the dance floor - and this was still the same right up to just a few weeks before he died. Roy also loved his bingo and was a regular at the Coalpit Heath Miners' Club.



Roy liked to help others and took on the mantle of Branch Welfare Officer for many years, visiting those who were ill or infirm, and he always had a ready smile and a kind word wherever he visited.

Roy served on the Branch Committee and rose to become Branch President. He will always be remembered by the Officers and members of Frampton Cotterell and Coalpit Heath Branch of the Royal British Legion.

Rest in Peace Roy.

"We will Remember them"

Remembrance Services:

Sunday 13th November, 11am at the Cenotaph, with service following at St Peter's and then later in the afternoon Parade with all service groups leaving from Royal British Legion at 2.30pm to St Saviour's in Coalpit Heath, for a short Remembrance Service and then parade back to the Legion for refreshments.



Thornbury Stairlifts
SALES SERVICING & REPAIRS

- New & Re-conditioned Stairlifts & Warranty
- Removals & Relocations
- Free Surveys & Quotes - No Obligation
- Rentals for Straight Stairs
- Independent, Professional & Friendly Advice
- Over 24 years practical experience



Independent Stairlift Specialist

01454 413 748 • 07833 318 722
www.thornburystairlifts.co.uk

News from Coalpit Heath WI

What a better way to spend an afternoon than being shown around a Gin Distillery. Bramley and Gage Ltd based in South Gloucestershire were our hosts for the afternoon. We were welcomed with a large gin and tonic, from their own range by our tour guides Nick and Sally. After the welcome talk, which included the origins of the distillery, we were given a guided tour. We were shown the preparation room right through to the packing area. Our guides were extremely knowledgeable, about their craft, very approachable and actively encouraged our questions. A number of Christmas purchases were made from the shop at the end of the tour.

Our October meeting saw a revisit from Catherine Dando from C Squared, who gave us first aid training, earlier in 2016. This time we were advised on the best courses of treatment for burns, including chemical and electrical burns. We were shocked to learn that anyone suffering from an allergic reaction could be dead within 3 minutes! These allergies can often be as a result of contact with nuts, shellfish, bees – this can be diagnosed by checking airways (often swollen), fat tongue, difficulty in breathing/whooping and anxiety. We were then given a demonstration on how to use the pen method of providing relief to sufferers. Catherine was asked to give us a refresher on how to dislodge obstructions from the throat and what to do in the event of someone choking.

Special thanks to Frampton Cotterell WI, who hosted a game of rounders at Crossbow. All in a bid for members to get some exercise and have some fun. We certainly did have fun, despite it being the hottest evening for some time and most of us were not used to running (or hitting the ball) – it was done in good spirit. We will have to think of another event for us to host a re-visit! Maybe something not quite so energetic.



Clinical Hypnotherapist

Catherine Smart DHP MNCH CHBP

Hypnotherapy can help you:



- Stop smoking
- Stop panic attacks
- Lose weight
- Improve your self-esteem
- Combat Fears and Phobias
- Easibirthing practitioner for labour and fertility
- Stress and anxiety



Hypnotherapy is widely used for all psychosomatic disorders (mental and emotional states which actually produce physical symptoms). In a nutshell, hypnotherapy can generally help with any problem you're finding hard to handle on your own - thoughts and actions you'd like to banish or acquire, or emotional suffering that is too overwhelming or has gone on too long.

Call me on: **07964 991689**

E: **Catherine@SmartHypnotherapy.co.uk**

Based in Winterbourne

Members are reminded that at the November meeting, we will collect goodies for our hamper raffle in December. There will also be the collection of the Operation Christmas Child boxes. December will see the collection of Christmas food for the Yate food bank.

We meet on the first Wednesday of the month in St Saviours Church Hall at 7.45pm, all visitors welcome.



Specialist Bicycle Build, Servicing & Repair

"It's all about the bike..."

From Mountain bike to Racers ~ Kids bikes to Commuters we will come to your home or place of work and keep your bike in peak condition.

- Servicing • Repairs • Bike Build
- Collection/Return • Mobile Service

Tel: **01454 838144 ~ 07870 574349**

www.rule4cycles.co.uk



~ rule4cycles

Focus On

Our Local Osteomyologist

Dawn Clode Lic MET, Lic CR, MAO

Dawn Clode is a warm, lovely person whose occupation as a healer, both of body and mind is one that she was born to do. Luckily for us her holistic health practice, launched in 2009, is now based in Little Stoke, where she also lives.

So what exactly is Osteomyology?

If we start by breaking the word down, Osteo means bone, myo means muscle, ology is a suffix meaning 'the study and treatment of'.

The Association of Osteomyology's website states, "...Osteomyology puts aside the usual tunnel vision of rigidly trained philosophies and allows the practitioner to switch seamlessly from one bodywork protocol to another even combining some methods together, this way the practitioner is never defeated as his/her armoury is limitless".

Treatments available. Having so many helpful tools in her kit to call upon when treating her patients is one of the many things Dawn loves about being an Osteomyologist. A selection of the treatments she is qualified to practice include; Acupuncture, Aromatherapy, Confidence and Self Esteem Coaching, Cranial Sacral Therapy,

Joint manipulation (HVT), Life Coaching, Massage, Muscle Energy Technique (MET), Neuro Linguistic Programming (NLP), Reflexology and Reiki (Dawn is a Reiki Master).

Common pain relieved or cured.

Conditions that Dawn frequently, successfully treats include; Frozen shoulder, RSI, back, neck and joint pain, depression, stress and low self esteem.

Having suffered severe back pain for over 20 years herself before discovering Osteomology, Dawn has

a strong sense of empathy with her patients. Using her tool kit of holistic therapies to help people have less physical or emotional pain makes Dawn's job a joy. "Witnessing my patient's relief of pain is like winning the lottery".

If you are living with pain or know somebody that is, NOW is the time to get it sorted out.

Reader Offer: £10 off your first appointment!

Visit www.life-and-soul-empowerment.co.uk for full details or call Dawn on **0795 1099 491**.



Dawn performing Cranial Sacral Therapy.

2 for 1 from £69

Bradley Stoke The Willow Brook Centre. Tel 01454 275 020

Specsavers

Cannot be used with other offers. Second pair from £69-£169 ranges, to the same price range or below and to the same prescription. **£69-£149 ranges:** 1.5 single-vision lenses included in both pairs. For 1.5 varifocal or bifocal lenses, you pay for the lenses in your first pair. **£169 Fineform and Rimless ranges:** 1.6 lenses included in both pairs. Single-vision: included in both pairs. Varifocal/bifocal: you pay for the lenses in your first pair only. All lenses are scratch-resistant. Extra Options available at an additional charge on both pairs. Excludes safety eyewear. SKU 25672008. ©2016 Specsavers. All rights reserved.

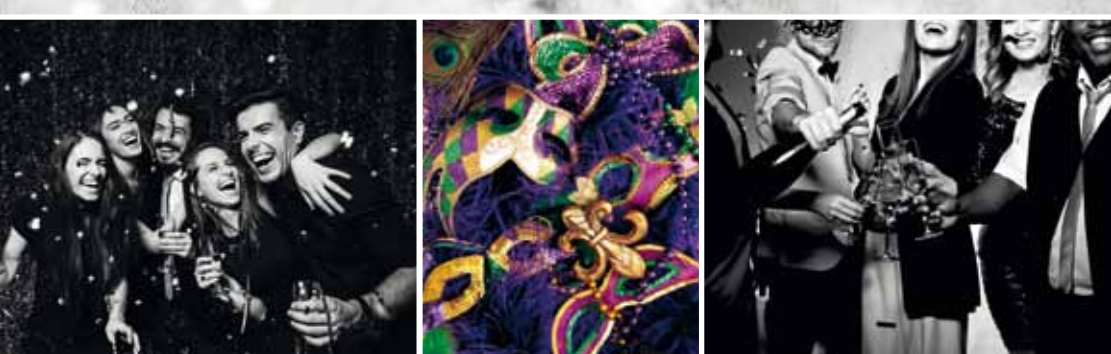

News from Floral Friends of Frampton

Autumn Tidy for Woodend – Floral Friends have been busy tidying the Woodend/Beesmoor strip of wild flowers. Seeds have been collected for next year's displays and bulbs have been planted to improve our Spring display.

Planters and Hanging Baskets – The summer displays are coming to an end now and we hope that everyone has enjoyed them. The planters and hanging baskets around the village will have their plants replaced with winter bedding over the next few weeks; we hope the displays will brighten the winter days to come!

Bulb Planting – During October more bulbs were planted around the village and in Crossbow Park, Floral Friends are grateful to all the kind local residents who have donated bulbs this year.

Scarecrow Preparations – As you can see by the picture above, at time of writing, preparations are well under way for Floral Friends' contribution to the Frampton Cotterell Village Scarecrow Trail held at the end of October. This year the theme is the Olympics, we hope you enjoyed spotting our Olympic scarecrows on the bench outside St Peter's Church.

Much more information about our activities is available on our website – <http://ffframpton.wix.com/fframpton-cotterell> – and if you'd like to help us (no gardening experience necessary!) please email us at floralfriendsofframpton@gmail.com



Experience a Christmas party with a difference at the MERCURE Grange Hotel

Christmas Carnival Parties

Murder Mystery Masquerade Evenings

Michael Bublé does Christmas Tribute

Swinging 60s party night with the Fab Beatles Tribute

ALL THE JOY OF CHRISTMAS AT MERCURE

For more information on our festive events and offers please contact us on:

01454 777 333

christmas@mercurebristol.co.uk

mercure.com/festive/mercurebristol • [@mercurebristol](https://www.facebook.com/mercurebristol)

Mercure Bristol North, The Grange Hotel
1 Old Gloucester Road, Bristol, BS36 1RP

Winterbourne International Academy Christmas Craft Market

Artwork
Candles
Chocolate
Beauty
Cakes
Woodwork

Gifts & Decorations
Toys & Teddies
Books & Jewellery
Clothes & Handbags
Entertainment
Raffle

High St, Winterbourne
Sat 19th November - 10am-3pm
Refreshments available



BEAUTY PLUS By Myriam



Treat your loved ones

...To a pampering Christmas GIFT
Voucher and receive 10% extra
when you spend £50-£99

Or 15% extra when you spend £100 or more
Call to book your appointment today
and avoid disappointment

01454-776938 / 07854-608889
147 Church Road, Frampton Cotterell, Bristol BS36 2JX



Orchard Harvest Day 2016

Over 1000 people visited Winterbourne Medieval Barn on October 2nd, to enjoy the most beautiful, warm sunny day, for this year's Orchard Harvest Day. There was a comprehensive programme of events throughout the day, including live music from Bygonz historical instruments, the Frampton Shantymen and the UWE Jazz band, plus demonstrations of rural crafts, cider-making, archery, falconry, a vintage traction engine, Winterbourne Down Border Morris, dry stone walling, and of course the crazy ferret-racing!

The crowds enjoyed locally produced barbecued lamb burgers and delicious ice-cream, Cotswold beer and Madhatter cider, as well as Lorraine's fantastic pasties and cakes. Children had a chance to hold a hawk, fire an arrow, play skittles, 'splat the rat' and look at the llamas, geese, pigs, and horses. It was a fantastic day out for all ages, with something for everyone. If you missed it – see you next year!



Carols in the Barn

Saturday 10th December
&
Sunday 11th December

4pm

Gates open at 3.30



at
Winterbourne Medieval Barn

Church Lane, Winterbourne, BS36 1SE

To ensure your place

Tickets £2 (£1 for children) to include mulled wine, fruit juice & mince pies

from

Daisy's Coffee Shop, Flaxpits Lane, Winterbourne
or phone 01454 774479

or see www.WinterbourneBarn.org.uk

**LIMITED PARKING, PLEASE WALK IF YOU CAN
APPROACH BY CAR FROM BEACON LANE ONLY**

Wrap up warm!

Bring a torch

Uneven floors



**Carols in the Barn - Saturday 10 December
and Sunday 11 December, 3:30pm**

Winterbourne Medieval Barn makes a perfect setting for a traditional Christmas celebration. Carols in the Barn will take place on two consecutive afternoons, with gates opening at 3.30pm for visitors to enjoy mulled wine, fruit juice and mince pies, before the carols begin at 4pm. The wonderful medieval barn provides an atmospheric setting for everyone to sing their favourite carols, which will be interwoven with a dramatised version of the Christmas story put on by members of neighbouring St Michael's Church.

Tickets are £2 for adults, £1 for children, which includes mulled wine/juice and mince pies. They will be available from 7th November from Daisy's Coffee Shop, Flaxpits Lane, Winterbourne, or ring Gill on 01454 774479. There may be some tickets on the gate, but numbers are strictly limited so availability on the day cannot be guaranteed.

Only limited parking will be available on site, so where possible please walk to the Barn. If using a car, please approach from Beacon Lane only. (ie. one-way system exiting onto Winterbourne High St).

www.winterbournebarn.org.uk

News from Frampton Cotterell WI

The big event for us this summer was the wonderful Frampton Festival which we all felt was a big success, in spite of the sunshine being rather shy on the day. That said, it didn't rain and the turnout was impressive, so we really can't complain. Our members did a great job in baking a wide range of cakes, scones and snacks for sale on the stall, and also in selling them – at the end of the day we were left with no stock remaining, thanks to everyone's efforts.

In August we take our traditional annual break from the monthly meeting, however members took part in a country walk in late August followed by afternoon tea at Poplars Farm Shop – this time the weather was on our side and so we were all able to enjoy the sunshine. We also had a summer rounders match in September where we took on Coalpit Heath WI, although our congratulations must go to our opponents who (sadly for us), beat us fair and square!

At time of writing we are looking forward to a talk on Coastal Marine Life and December brings a number of social opportunities with a festive note, including carols, a Christmas Bingo night at Crossbow House, our book club Christmas meal and our contribution to the Christmas Tree display at St. Peter's Church. And a new events programme for the New Year is currently being organised.

Visitors are welcome to our monthly meetings at St Peter's Hall on School Road at 7.45pm, on the 4th Tuesday of the month. There is a charge of £2.50 for the evening and any new members can join by paying a membership fee. Special interest groups that meet separately including a book club, choir and our skittles and darts teams. Please search FramptonCottWI to find out more, and do like our page.



SMOKEHOUSE Saloon

At THE SWAN, 114 HIGH ST, WINTERBOURNE BS36 1RE

THE HOOITEST, TOOTIEST, CHUCK WAGON EAST OF THE PECOS!

AUTHENTIC AMERICAN SMOKEHOUSE

REGULAR LIVE MUSIC

CHILDREN'S MENU AND PLAY AREA

TAKEAWAYS AND CHILDREN'S PARTIES

FORTHCOMING LIVE MUSIC EVENTS:

SATURDAY 29th OCT "ROADHOUSE"

SATURDAY 26th NOV "FAB TWINS + 1"

FRIDAY 23RD DEC - BAD KATO

01454 771 854

HOWDY@SMOKEHOUSESaloon.CO.UK

10% DISCOUNT

In conjunction with Winterbourne Matters, The Smokehouse Saloon is offering a 10% discount off its Smokehouse menu with this advert! (expires 30/11/16)



Community Noticeboard

For free listings contact
community@
mattersmagazines.co.uk

Severn Counties Foreign & British Bird Society

Venue: Winterbourne Down Methodist Church Hall, Down Road, Winterbourne Down, BS36 1BN

Meeting on 3rd Thursday of the month
Talks and slide shows at 8 pm

The local club for people of all ages interested in keeping birds. Monthly lectures, social events, day trips

www.foreign-britishbirds.info/index.html

Christmas Fair

at
St. Peters Church
Frampton Cotterell

SAT 19th NOV
2016
10.30 until 1pm

Hot/Cold Drinks
Cakes
Soup & Roll

FREE
ENTRY



FATHER CHRISTMAS
will be ARRIVING at 10.45am

DOWNEND HORTICULTURAL SOCIETY

Affiliated to the Royal Horticultural Society, National Vegetable Society & the Gloucestershire Federation of Gardening Societies.

Our meetings & shows are held at the Downend Assembly Hall, Salisbury Road, Downend, Bristol BS16 5RA.

Our next meeting on Nov 7th at 7.30 pm

A talk on Wild Flowers of the Wye valley

Non-members are always welcome (Entry £2.00)

Please see www.downendhortsoc.co.uk for details or telephone Hilary Walton on 0117 9792832 or Roger Davis on 0117 9571763

From September to May we meet on the second Thursday of the month at 7.30pm. Our evenings start with tea/coffee and homemade cakes or biscuits. From about 8pm we listen to a speaker on an horticultural related subject until about 9pm.

We are a friendly group of gardening loving individuals come and join us when you can.



Traidcraft Goods for Christmas

Coffee and Lunches

Saturday 5th November

Zion United Church



Frampton Cotterell

10.00 a.m - 3.00 p.m

Light lunches of soup or jacket potato available
12 noon □ 1.30pm in the Hall

Remember, Remember!

This year's bonfire and firework event organised by 1st Winterbourne (St. Michael's) Scouts will take place on 5th November at Sunnyacres Farm, Cloisters Road, Winterbourne.

Gates open 5 :30 pm ,bonfire at 6.00pm, fireworks at 7.00pm.

Burgers and hotdogs supplied by a local butcher and cold and hot drinks will be available.

Tickets (£4 Adults, £3 children) will be available in advance from Daisy's coffee shop in Flaxpits Lane or on the gate.

Please note, for safety reasons there will be no parking on site or in the lane near the site. Stewards will be able to advise on dropping off disabled persons.

Toilets available.

Contact 01454 775024 or email winterbournesmsgsl@cotswoldedgescouts.org.uk



ALMONDBURY PRIMARY SCHOOL CHRISTMAS FAYRE

6-8pm FRIDAY 2nd
DECEMBER 2016
IN THE MAIN HALL



All the usual stalls including chocolate tombola, the ever popular "Gift Room", children's crafts, nearly new toys and books, raffle etc.

Hot refreshments, delicious cakes and hot festive snacks.

You can purchase your Christmas tree* AND FATHER CHRISTMAS will be making a special appearance!

For more information call 01454 612517 or email almondsburyschoolpa@gmail.com
*(for collection on evening of the Fayre only)



ALMONDSBURY SCHOOL
SUNDAYS HILL, LOWER
ALMONDSBURY, BS32 4DS

Mining around Yate & South Gloucestershire

Yate & District Heritage Centre



11th October—26th November

Discover the rich history of mining & quarrying around Yate and see the amazing finds from recent excavations in the area.
Contact Yate Heritage Centre on 01454 862200, email us at yate.heritage@southglos.gov.uk or visit our website:
<http://www.yateheritage.co.uk>

Table Top Sale

At Coalpit Heath Village Hall
Saturday 5th November 1pm to 3pm
Tel: 07920 145352 to book a table

A tribute to the 80's with Retro Electro

At Coalpit Heath Village Hall
Saturday 12th November 8pm to late
Tickets available now £6 per person
Tel: 01454 776958

Elm Park's Marvellous Roald Dahl Day

Last term, children and staff at Elm Park Primary School celebrated 100 years of Roald Dahl. It proved to be a wonderful day with everyone coming to school dressed as one of Dahl's fantastic book characters.

Each key stage showed off their costumes during a fancy dress competition. The Enormous Crocodile and Violet Beauregarde stole the show in their respective key stages.

The children were completely immersed in the works of Roald Dahl; Key Stage One created a beautiful collage of the Enormous Crocodile, Lower Key Stage Two designed dreams in their own dream jars, and Upper Key Stage Two created new storylines involving a plethora of Dahl's most famous characters. Children also enjoyed a Roald Dahl themed school dinner.

It was a truly fabulous day topped off perfectly by a cake sale to raise money for Roald Dahl's Marvellous Children's Charity, an organisation that supports children with life-limiting illnesses. All cakes sold were kindly made and donated by some of our wonderful Elm Park families. A fantastic day all round!



News from St Michael's Church of England Primary School Winterbourne

We welcome Winterbourne Early Years preschool on to our site. We look forward to building a successful and long term relationship.



Winterbourne Early Years Centre is a registered charitable organisation overseen by a parent committee, and managed on a day to day basis an Early Years Professional and a team of qualified and experienced Early Years Practitioners. Based in the Greenfield Centre, Winterbourne Early Years Centre offers preschool provision for 2, 3 and 4 year olds as well as free community baby and toddler groups.

This September the centre has expanded to provide a wonderful new preschool provision; Rainbow Bears room at

St Michaels Primary School, Linden Close, Winterbourne, which is initially open on a Monday, Tuesday and Wednesday 9am – 3pm, and will expand to the full week as demand increases.

Rainbow Bears room is led by Preschool Leader Jean Essom (pictured top left), a qualified teacher in Early Years, and Deputy Preschool Leader Freda Walker (pictured bottom left), a highly experienced NVQ qualified Practitioner. The management of the setting is overseen by the Centre Manager, Sally Bowd.

The children have access to a wide range of stimulating learning activities both in and outdoors and will have the opportunity to learn through 'forest school' activities as Jean commences her Level 3 Forest School Leader qualification.

If you would like further information about 'Rainbow Bears' please contact Sam (centre Administrator) on 01454 773781 or email enquire@winterbournepreschool.co.uk

We look forward to hearing from you.



OSCARS is a well established playscheme providing before and after school club and holiday childcare for primary school aged children.



Holiday Childcare
Throughout the year.

Open from 7.45 until 6pm

Breakfast served until 8.15am

Book Full, Half or a School day.

See our website for full details

www.oscarschildcare.org.uk

The Terrapin Frampton Cotterell CofE School
Rectory Road Frampton Cotterell

E-mail: oscars.terrapin@btconnect.com

Telephone: 01454 250528

Registered Charity No: 1133716

Wizkidz

After School & Holiday Club
www.wizkidzclub.co.uk



Wizkidz club offers a wide range of activities specially designed to deliver the key elements of the EYFS, encouraging self-esteem, learning new skills and meeting new friends.

**Bookings now being taken for
Summer holiday club**

HOLIDAY CLUB HOURS

All Day ~ 8am - 6pm or 8am - 4pm

School Day ~ 8am - 4pm

Half Day ~ 8am - 1pm OR 1pm - 6pm

For More information or to book a session please
call Gemma on : 07845 900 434

The Manor Hall, Henfield Road, Coalpit Heath.

Events at WADCA

(Winterbourne & District Community Association)

Watleys End Road, BS36 1QG.

Friday 4th November – Britpop 90s Night with the Inflatable Sharks. A fantastic night with 90s hits from Oasis, Stereophonics, Supergrass, Ocean Colour Scene and much more. Doors open 8pm. Band starts at 9pm. Tickets £8. To pre-book contact WADCA on 01454 776268 or email ca.winterbourne@gmail.com or find us on facebook.

Wed 7th – Fri 9th December – “Trial by Jury” and music from “Me and My Girl” and “Salad Days”. Three very different British musicals from the 1870s, 1930s and 1950s, to celebrate 40 years of Winterbourne Musical Theatre. Tickets £9 from 01454 317408. www.winterbournemusical.co.uk

All sorts of activities available – Why not check out the range of regular clubs and societies that meet at WADCA (badminton, bowls, karate, scrabble, theatre, etc) and try a new activity for the winter.

For details about local clubs or facilities for hire visit www.wadca.co.uk / 01454 776268.



Based at The Greenfield Centre in Winterbourne
our Ofsted rated ‘Outstanding’ centre provides a range of services for local families

Pre-School sessions from 2 years:

*Integrated Forest School activities
Highly qualified and experienced staff
forming a well established team
Grant funding for 2, 3 & 4 yr olds
Strong links with local schools*

Free Community Groups:

*Baby Group, Toddler Group,
Stay and Play sessions*

For more information or to arrange a visit please
call Sam on **01454 773781** or see the website

www.winterbournepreschool.co.uk

E: enquire@winterbournepreschool.co.uk

The Greenfield Centre, Park Avenue, Winterbourne

Funding Boost for Community Sensory Garden

Floral Friends of Frampton are celebrating the news that they have received a £8,425.00 funding award from SUEZ Communities Trust (formerly SITA Trust) for a Community Sensory Garden.

The award will allow the group to create an attractive, tranquil space at the heart of the village and will aim to benefit residents of all ages, from young children to older folk.

It will be carefully planted with colourful, fragrant and tactile plants and will be fully accessible, with seating and picnic benches providing a place for people to meet. Spaces for bird feeders, a bug 'hotel' and homes for bees and other insects will be provided thus enhancing the space for all!

Celia Zlobec, Chair of Floral Friends of Frampton said, "We are delighted to receive this funding which will help us to provide an oasis of beauty and tranquillity in the centre of our village for residents and community groups to enjoy."

Lisa Helyar of SUEZ Communities Trust added "Floral Friends of Frampton are an enthusiastic voluntary community group, set up to improve their local environment by planting flowering plants around the village of Frampton Cotterell. Our funding will see the creation of an attractive community sensory garden that will be accessible to all. We can't wait to see how this project evolves. SUEZ Communities Trust provides grants through the Landfill Communities Fund. This important source of funding has been available since 1997 and has provided such worthy projects with more than £1.4 billion."

Winterbourne & Frampton Matters looks forward to keeping you posted on this exciting prospect for the local area, congratulations Floral Friends!

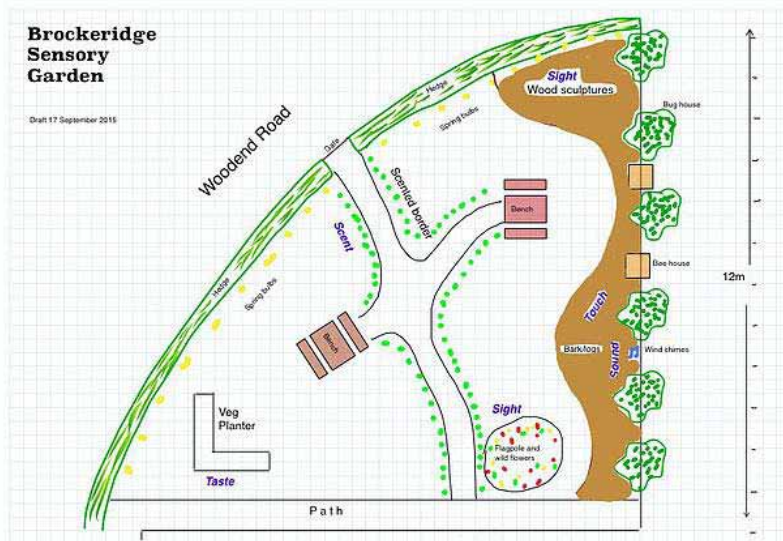

UWE Students Build Bird boxes for Two Local Woodlands

UWE student volunteers at a recent UWE volunteering day built a number of Bird Boxes for the Sims Hill Community Woodland, which lies in the Winterbourne Parish Council area and is round the edge of the Bristol Business Park near UWE, and its nearby sister woodland, Splatts Abbey Wood, which is near the MoD and Cheswick Village.

Both woodlands have developed a close relationship with the University of the West of England and the Students' Union at UWE. Jenny Idle, Project Officer at UWE Volunteering told us "The students had a great time learning a new skills, alongside other highly skilled students from the Centre for Performing Arts. It is hoped that the

bird boxes will have a lasting impact in the woodland and encourage a greater number and variety of birds to our local area".

The two woodlands are delighted with the boxes, which they will put up at workdays.

"It has been a pleasure for myself and students from UWE to participate in the creation of these bird-boxes, further establishing the close ties which the students and university have with both woodland sites. We look forward to this relationship continuing and the resumption of our workdays - in which we hope to see the bird-boxes put to good and lasting use."

Thomas Haines, UWE GreenSpace Project Leader

David Bell, Chair of Splatts Abbey Wood Group commented "The Bird Boxes are great, and will be put to good use and we are very grateful to the UWE volunteers for making them for us. We look forward to developing our woodland through the workdays."

The two woodlands are holding workdays and would like to get more community involvement in their group, including recruiting more volunteers. So if you are interested in finding out about your local woodlands and getting involved in conservation activities please get in touch.

Both woodlands run work days which include activities such as cutting back brambles, clearing pathways in the woodland and coppicing trees. No experience needed as they will train you on the day and it's a great way to learn a new skills, get some fresh air, meet new people and get a bit of exercise!

Why not get in touch to give it a try and see if you like it?

The Sims Hill Woodland Committee can be contacted at: simshillcw@gmail.com

The Splatts group can be contacted via: splattsabw@gmail.com

Susan's Pet Care
www.susanspetcare.net
M: 07706036738
susan.slides@btinternet.com
Insured & CPD Checked

Trained & Experienced Dog Walker
Pet sitting in your own home inc. dogs, cats and small animals.
Pop-in visits
Dog and Cat grooming inc. clipping, hand stripping, wash and blow dry, ear cleaning, ear plucking and nail clipping by a trained groomer either in your own home or at grooming parlour.
Trained in Small animal and Dog First Aid

BUBBLES DOG WASH
Dog and Cat grooming spa.

- No Cages • Nail Clipping • Ear Cleaning
- Scissoring & Clipping • Hydro-Bath

Professional Affordable Luxury for your pet

Call 01454 856159
E: info@bubblesdogwash.com
www.bubblesdogwash.com
unit 2a, Mays Hill Industrial Estate, Frampton Cotterell.

COMPANIONS HAVEN
— PET CREMATORIUM —

For when the time comes to say goodbye.....

Companions Haven is a family run pet crematorium, specialising in individual cremation for over 20 years. Set in beautiful grounds between Bristol and Bath in the village of Pucklechurch.

200 Westerleigh Road
Pucklechurch Bristol BS16 9PY
Tel: 0117 937 4554
www.companionshaven.co.uk
info@companionshaven.co.uk

700 Year Celebrations at St Peter's

As a part of our 700th year celebrations we held an open weekend and invited the local community to come and toast the tower with us.

On the Friday evening there was a Folk Evening at which there were a number of singers and groups from around the area. A reasonably full church was treated to some excellent entertainment and we were grateful to those who helped set everything up for this event. The bar and refreshments were busy during the evening and added to the pleasant atmosphere in the church.

On the Saturday the church was open to visitors. There was plenty of room in the newly arranged back of the church for coffee, lunches and cream teas as the day progressed. There were various displays in the church including some of the old documents from the church archives which proved popular and very interesting.

The weather was quite good during the day which enabled lots of our visitors to take a trip up to the top of the 700 year old tower to enjoy the views around the area and to see the bells and the clock mechanism. These tours were much appreciated by our visitors. During the day the visitors were also entertained by David our organist and by a group from The Crossbow Singers which all added to a very pleasant time in the church.

Sunday brought the close of the weekend with a Songs of Praise service for the benefice, during which the new room, and the moving of the font were dedicated and blessed for us all. There were some final celebrations with tea and cake helping us all to relax after the busy few days. Our thanks once again must go to all those involved in any way with the planning and organising of the weekend.



MEDWAY DESIGNS for Cakes & Sewing

Wedding Cakes	Bridal Wear
Anniversaries	Alterations
Birthdays	Evening Wear
Christmas Cakes	Day Wear
Special Occasions	Soft Furnishings & re-upholstery

Delivery & Collection Service Available

Lois Coulson
0117 969 1798

lois.coulson@medway-designs.com

14 Watch Elm Close
Bradley Stoke

Call now for a friendly personal service



**desktop and laptop PC
help & repairs**

01454 838 488

help@winterbournecomputerservices.co.uk

fast, friendly and efficient computer support
for home & small business users – serving
South Gloucestershire and North Bristol –
we come to you, no call out fee

The Parishes of Frampton Cotterell, Iron Acton, Winterbourne and Winterbourne Down in THE DIOCESE OF BRISTOL

Dear Friends

So it is official we are now a Benefice, the Archdeacon commissioned and blessed us all at Iron Acton in a wonderful service and celebration on the 9th October. However the truth is, we have legally been a Benefice since the 27th July, so now both the Diocese and the Crown have given their blessing so its full steam ahead, all we need is the New Rector!

On the 8th December I will take up that position and together we will begin an exciting and challenging journey to truly establish the 'Fromeside Benefice' as a living and vibrant faith Community. Four distinct parishes, with their own traditions and uniqueness working together for the 'Kingdom of God' in this beautiful part of his world. What we can do better together we will and as for the rest we will encourage and offer loving support to each other in the key areas where we continue to minister in our particular local communities. We will be, I hope, a living example of 'Unity with Diversity'.

I have been asked to share with you this month what my priorities are? I believe there are three key areas which we need to focus on over the next 18 months;

1. Establishing the Benefice
2. Equipping ourselves for Discipleship and Mission
3. Work with Young People, Young Families and the Local Schools

We have already done a considerable amount of work here and our key focus will be to develop it further and cement our working partnership effectively. However as further ideas and initiatives grow, I want to see more of us readily embrace our corporate action, laying aside the limitations of parochialism, There will be so much more we can do effectively together if we share resources, use our many gifts and skills strategically, both underpinned with prayerful love.

If we are to successfully make connections within our communities bringing new disciples to faith within the Christian Community we have to first deepen our own faith both in study and prayer. I want to see the establishment of Study/Prayer Groups, meeting regularly to enable both study of and nurture in the faith, availing to everyone support and care. All this is vital if we are truly to discern Gods will for us as we move forward. If we are to make disciples of others I feel we must build ourselves up for the task ahead.

In the New Year I will be bringing together all who work with young people in our Parishes to discuss our strategy for taking this vital work forward. It seems to me that our greatest priority is to work with the Young and Young Families. Hopefully by Easter we will have introduced an alternative service to engage with those on the fringe of Church life and those who are seeking. I will also be giving a high ministerial priority to my work with the three Church schools and trying to establish stronger links with the other schools in the Benefice area. We must never forget that young people are 'The Church of today and the hope for tomorrow'.

It is for me a great privilege to serve you all as your New Rector, I believe deeply that God is calling us together to enable something powerful to happen for the Kingdom in our Benefice area. We will make

connections with the local communities and each other, we will build on the traditions we hold dear and which have been established so lovingly over the years. But most of all, our four Parishes together will be a solid rock on which the Christian faith continues to be built and where love of God and love of neighbour will be at the heart of all we do.

Exciting times! God Bless

Malcolm Strange



All Saints Church, Winterbourne Down

The Dodington Parish Band will be performing their Christmas Concert at All Saints on Saturday 17th December, 7.30pm

Tickets available from Wendy 01454 886070 or come on the night. £10 per person to include canapes and wine.



New Service 'COMMUNITY CONNECTORS' launched to help local residents improve their wellbeing

Community Connectors is a new service designed to counter social isolation and loneliness by helping people re-connect with each other, local services and communities. The service is a three year programme and is being delivered in partnership with Curo, a not-for-profit housing and support organisation, and will involve GP surgeries, the Voluntary Sector and local community groups working across the whole of South Gloucestershire.

Support available includes:

- Information and guidance over the phone, face-to-face or by email
- Tailored support to help people play a more active role in their communities
- Help to set up groups and activities that benefit their community
- Opportunities to meet new people, learn a new skill or to volunteer
- Sign-posting to local services and agencies.

Who would benefit from being referred to Community Connectors?

The service is being targeted at the following groups:

- People regularly presenting at GP practices whose wider needs cannot be supported through traditional medical treatments on their own.
- People at risk from or experiencing social isolation and loneliness who may not be eligible for statutory services.
- People who's physical and mental wellbeing needs may also be met through non-medical interventions and can be supported through "social prescribing".
- People who have experienced a life-changing event that has impacted negatively on their confidence and wellbeing.

Referring individuals – Council staff, South Gloucestershire based GPs, community health and voluntary sector partners can all refer to the scheme. Additionally, individuals can self-refer:-
By calling Curo's dedicated phone line: 0300 123 2464 or email – communityconnectors@curo-group.co.uk.

For more information and to discuss how these services could benefit your service users, please contact Jack Bailey jack.bailey@curo-group.co.uk or Robin Woodward robin.woodward@curo-group.co.uk at Curo.

Frampton Singalong meets on first Thursday afternoon in the month, 2 pm – 3.30 pm at The Community Centre, Crossbow House, School Road, Frampton Cotterell, where members of the community can enjoy singing favourite songs lead by experienced singers and musicians and take a break for cup of tea and homemade cakes. The next Frampton Singalong is on Thursday 6th October 2016, 2 pm.

Frampton World Dance meets on 4th Thursday afternoon in the month, 2 – 4pm at Zion Church Hall, Upper Chapel Lane, Frampton Cotterell, BS36 2HY. The dances are taught by an experienced teacher, are suitable for beginners of all ages and no partner is needed. They are gentle dances from around the world including from Balkan, Jewish, Greek, Welsh, English and other traditions and danced to live music. The next Frampton World Dance will be on Thursday 27th October 2016.

Community Connectors are looking for volunteers interested in helping with to run these groups. Circle dance teachers, singers and musicians are also welcomed. For more information about these groups or to volunteer please contact Hilary Jay, Wellbeing Worker, Mob 07792 495 367 or email: hilary.jay@curo-group.co.uk



**We have re-branded
come and visit us...**

Instore Butchery

*Licensed cafe serving great food
eat in or take away.*

*Homemade ready meals, pastries
and pies, cakes, quiches and snacks.*

Fresh fruit and veg

Catering

Private Venue Hire

We are on the Frome Valley walkway.
Our covered terrace is great for dog walkers

Lots of events planned

Come and support a local business.

Check out our social media for updates

@poplars_farm poplarsfarm

Poplars Farm, Bristol Road, Frampton Cotterell, Bristol.

01454 773964

www.poplarsfarmshop.co.uk

Winterbourne Musical Theatre December Production.

Continuing their celebration of four decades of performances in our local area, the Winterbourne Musical Theatre's December production will feature their very first show staged – *Trial by Jury* by Gilbert & Sullivan. As this is only a one act work the remainder of the evening will feature extracts from two of their favourite shows from the last twenty years – *Me and My Girl*, and *Salad Days*.
See full performance details below.

Winterbourne Musical Theatre
presents

40 years and counting

A celebration of four decades of musical entertainment.

Trial by Jury

By Gilbert and Sullivan.

Repeating the company's first production

Plus extracts from:-

***Me and My Girl*
and**

Salad Days.

Two favourite shows from the last 20 years

**Wednesday, Thursday & Friday,
December 7th, 8th & 9th 2016.
At 7.30pm daily.**

**Winterbourne Community Centre,
Watleys End Road, Winterbourne.**

Tickets £9 (including nibbles).

Telephone 01454 317408

**ALEXANDRA CORK
HOME DESIGNS**
Architectural plans drawn
for your home

QUICK ACCURATE ~ AFFORDABLE SERVICE
FREE CONSULTATION DESIGN & ADVICE

SURVEYS AND PLANS DRAWN
PLANNING PERMISSION SOUGHT

**07867 592195 • info@alexandracork.co.uk
www.alexandracork.co.uk**



Fab Family Nature Events at Says Court Farm

Right at the end of August, Avon Wildlife Trust was joined by the Hawk and Owl Trust and six families to peek out the last of the summer holidays with a family nature day and picnic at Says Court Solar Farm.



In the glorious sunshine, armed with digital cameras to record our nature finds we walked across the farmland to the new wildflower meadow, stopping on route to look at the owl box and learn all about the birds of prey who use the farm. We also spied a wheateater in the field stocking up before its long journey to central Africa.

Once in the wildflower meadow, surrounded by bird's foot trefoil, oxeye daisies and red clover, we went on a mini-beast hunt. Grasshoppers were the most impressive find, but we also found butterflies and ladybirds as well as bugs, spiders, flies and much more. Everyone also had the opportunity to make a bird feeder and bug hotel to take home – to encourage wildlife into their gardens. There was even time to do a spot of charcoal drawing, taking inspiration from what we had spotted on our walk and bug hunt. We all then relaxed over a picnic and took time to edit our photos (or take more!) before heading our separate ways again.

Did you know?

- Says Court Farm is a fascinating site with a solar farm at its heart. In addition to 84 acres of solar panels, two new wildlife areas have been created to improve biodiversity and benefit the residents of Westerleigh. As the site develops Avon Wildlife Trust will provide opportunities for people to explore the area and discover more about the nature on their doorstep this event was the first. There is also a 3 mile circular walk which is great to enjoy at autumn time (featured opposite).
- The new eastern habitat consists of a barn owl hunting corridor of tussocky grassland plus a species rich grassland and is crossed by the public footpath, enabling walkers to enjoy this new nature rich landscape alongside the fast flowing stream.
- Over 97% of all flower-rich grasslands have been lost in Britain since the 1930s, reducing pollen and nectar sources and leading to a serious decline in the wildlife depending on wildflower-rich habitat. The creation of new flower rich meadows will provide essential food for pollinators who in turn provide food for us.
- The solar panels on Says Court farm have been generating electricity since April 2014. Avon Wildlife Trust and Westerleigh parish council are working alongside the landowners and AEE Renewables to restore the natural environment and increase biodiversity alongside increased renewable energy capacity.
- The addition of native hedgerow plants such as hazel, hawthorn, blackthorn and field maple will thicken old hedges, create new natural corridors and provide valuable flowers and berries for insects and birds.



After the success of the family nature day, the Avon Wildlife Trust and Hawk and Owl Trust came together again at Says Court Solar Farm for an Owl and Bat evening.

People and Wildlife Officer, Nicole Daw shared with us the below account.

At the end of September, we were joined by 26 people from the local area which was fantastic. We started by dissecting owl pellets and had some fascinating finds.

They could tell all the owls had a taste for voles (including one of the largest vole skulls I have ever seen) but there was also some shrews too!

As dusk settled we started on our walk around the farm. Though we didn't see any owls in flight we were treated to lots of interesting owl and general nature information including what makes a good nest site and how owls fly silently. As darkness descended the bats came out and we could pick them up on the bat detectors as they swooped overhead. At the end of the evening we were all treated to saying hello to a native tawny owl and a native barn owl that Dave and Paul from the Hawk and Owl Trust had bought along. Both owls were beautiful and very happy to pose for photos.

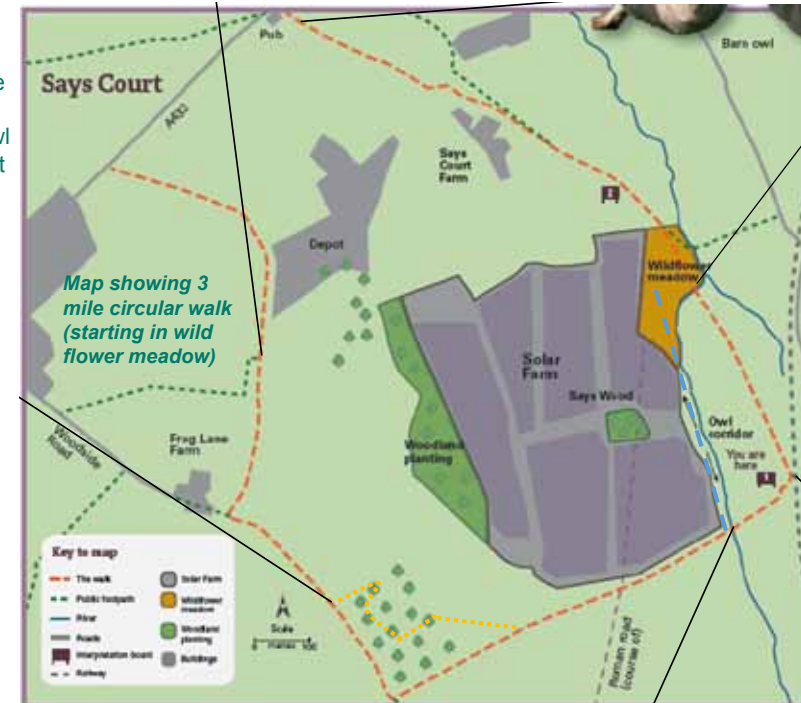

News from the Crossbow Singers

The Crossbow Singers are now busy rehearsing for the Christmas Concert. This will take place on Monday and Tuesday, 12th and 13th December.

As usual, the programme will be packed full of seasonal melodies designed to put you in the Christmas mood. Our Musical Director, Carolyn Dutton, has been putting the choir through their paces, aimed at bringing out the best possible sound. So please come along and support your local choir.

The concerts start at 7.30 and tickets are £6 each. These will be available from November 1st, by contacting Rose on 01454 772675 for Monday tickets, or contact Mary on 01454 887885 if you would like to come along on Tuesday.

New Tenors & Bases Needed!

As always, and sadly in common with many mixed choirs, The Crossbow Singers are in need of more tenors and bases. A friendly group of about 35 members, they meet each Monday evening during term time, starting at 7.30 and finishing around 9.00 pm. Although helpful, it is not necessary to be able to read music – all 4 parts are practiced thoroughly. However, a love of singing is essential! So, if you sing tenor or bass and have Monday evenings free, why not come along and give the choir a try? Better still, why not come to one of the Christmas Concerts? It would be lovely to meet you.

The Crossbow Singers rehearse at Crossbow House (in the main hall), School Road, Frampton Cotterell, and this is also where the concerts are held.

A warm welcome awaits you - see you there!

Chris Palmer, Choir Secretary

Events at St Saviours Church Coalpit Heath

Saturday 3 September was St Saviours Church Coalpit Heath, Annual Horticultural Show. The day was once more a success, with people entering into the competition classes and exhibits. Children took part and won prizes too. The Ride and Stride event was enjoyed, members walked to St Peters and then onto Bridge House for Tea and Super Train rides.

Saturday 5 November – 10am – Full peal of church bells.

Saturday 12 November – A Welcome Festive coffee morning in the church hall 10am – 12 noon.

Saturday 26 November – Our Christmas Fayre will be at 2pm with several stalls also light refreshments do come along and enjoy.



CAN YOU READ THIS? WOULD YOU LIKE TO HELP THOSE WHO CAN'T? WELL YOU CAN:

Please send us your used postage stamps and take on the fight! (Stamps cut outside the perforations will earn the charity more) We are also grateful for any unwanted stamp collections, old and foreign coins, £3,304.95 has been raised to date.

Your Contribution Will Make A Difference.

The Difference – Money used by RP Fighting Blindness goes to the help line service and research into a cure for the disease which affects 25,000 people in the U.K.

We Talk – For anyone wishing to know more, we do a 35 minute talk to groups and clubs which is light hearted, informative, to promote awareness of the condition.

Thank you to everyone who has helped us to date. You have made a difference. For further information from Ron & Gina Pritchard, Winterbourne, Tel 01454 772927 or Email bristolsglosfightingblindness@gmail.com

HARBORD
OPTICIANS

Welcome to Mike Harbord Opticians - a family practice in Winterbourne Village.

Friendly, personal service and advice.

Full Eye Examinations and Retinal photography.

Qualified Optometrists and Dispensing Opticians.

A wide range of spectacles from NHS to handmade and bespoke frames.

Call today for an appointment
01454 775530

3 WHITEGATES, FLAXPITS LANE, WINTERBOURNE BS36 1JX

Emma and Jo have lost 4 stone 3 pounds together!

Emma's Story – I had always been slim as a young adult. In 2011 I returned to the UK from the Phillipines where I had been working but as I readjusted back to UK life, I began to put on weight. I made all kinds of excuses about it - it was the stress, it was English food, it was the weather, it was...my age...! The final straw came when I went for a routine medical appointment and the nurse said, 'You're overweight'.

So early in January 2016 I said to Jo, 'we're off to Slimming World this evening' and we went along to Watermore Infants School in Frampton Cotterell. Just over 6 months later I reached my target weight, having lost 1 stone 10 lb. Jo joined me at target a few weeks later.

I feel better, look better, and I'm much fitter. I had begun to hate pictures of myself and now I'm actually pleased and relieved when I see pics of me, and I've stopped avoiding the camera!!

Jo's Story – Like Emma, I had recently visited the GP surgery for a health check, and was shocked to hear the nurse tell me my weight. I knew that I should address my continuing weight gain, but it was hard to actually DO something about it.

So when I came in from work on the first Monday of 2016 and Emma said we were off to Slimming World, I was slightly taken aback.

But I decided to commit to the Slimming World way of life, and my mind-set around food changed.

Also, I started taking the dog for far more walks, walking between offices at work, and even running. It helped massively that Emma and I followed the Slimming World way of life together,

cooking and eating the same healthy food and encouraging each other - perhaps even being a bit competitive!! I finally hit my target weight loss of two and a half stone in early August. I am enjoying being consistently lighter that I have been for about twenty-five years, and feeling so much better for it!



Emma & Jo - before & after, below



live happy!
with
Slimming World

Monday	Tuesday	Wednesday	Friday
Frampton Cotterell	Winterbourne	Frampton Cotterell	Coalpit Heath
Watermore Primary School Opposite the Brockeridge Centre, Woodend Road 5.30pm & 7.30pm Tel: Alison 07972 376055	The Greenfield Centre Park Avenue 9.30am, 11.30am 5.30pm & 7.30pm Tel: Frankie 07519 347243	Frampton Cotterell C of E Primary School, 7.30pm Tel: Lisa 07815 759118	The Manor Hall Coalpit Heath, 7.30pm Tel: Lisa 07815 759118 New Morning Group

slimmingworld.co.uk 0344 897 8000
Facebook Page: Frampton Cottrell and Winterbourne Slimming World

touching hearts, changing lives

Frampton Cotterell and Coalpit Heath Village Diary

November 2016

Thur 3rd - Community Singalong, Crossbow, 2-3.30pm. £3 includes tea and cakes.

Fri 4th - 90's Britpop night with live band, WADCA from 8pm. £6 in advance, £8 on door. Bookings T. 01454 776268 or 07467 319373 / email: ca.winterbourne@gmail.com

Fri 4th - Quiz night, Crossbow, 8pm. Open to anyone £1.50 Tel. 01454 772947 www.fcdca.co.uk

Sat 5th - Traidcraft Christmas Sale, Zion Hall, 10am-3pm. Light lunches, teas, coffees.

Sat 5th - Table Top Sale, Coalpit Hth Hall (The Miners), 1-3pm. Table £5 Tel. 07920 145325.

Wed 9th - Carer's Club, Zion, 2-4pm. Carers welcome to stay with the person they care for or use the free time as they wish. More details from Jean 01454 775786 or Rona 01454 886925.

Fri 11th - Folk @ Frampton, Crossbow, School Road, 8pm, small charge. All welcome.

Sun 13th - Bingo Night, WADCA, Watleys End 7pm. Tel: 01454 776268 www.wadca.co.uk

Thu 17th - Community World Dance, 2-4 pm, Zion Church Hall.

Fri 18th - Bingo Night, Crossbow, 8pm. All welcome. Tel. 01454 772947 www.fcdca.co.uk.

Sat 19th - St Peters church Christmas Fair, 10.30am-1pm.

Tue 22nd - Frampton Cotterell WI, St Peters Hall, School Rd, 7.45-10pm Tel. 01454 773426.

Wed 23rd - Singalong Group, Zion, 2pm-3.30pm. For local people who enjoy a singalong! Details from Jean 01454 775786 or Rona 01454 886925.

Thur 24th, Fri 25th & Sat 26th - Winterbourne Players host a Murder Mystery evening, WADCA 8pm. Tickets £8 incl nibbles. Sit in teams of 6. Tel. 07899 808943 or winterbourneplayers.co.uk

Wed 30th - Litter Busters, meet 10am Gingerbread Man cafe. All welcome.

December 2016

Thur 1st - Community Singalong, Crossbow, 2-3.30pm. £3 includes tea and cakes.

Fri 2nd - Brass Band concert, St Peters church, 7.30pm.

Fri 2nd - Quiz night, Crossbow, 8pm. Open to anyone £1.50 Tel. 01454 772947 www.fcdca.co.uk

Wed 7th, Thur 8th & Fri 9th - Winterbourne Musical Theatre '40 Years & Counting' triple bill show, WADCA, 7.30pm. Tickets £9 from 01454 317408. www.winterbournemusical.co.uk

Sat 10th & Sun 11th - Carols in the Barn, Winterbourne Medieval Barn, 3.30pm. Adult £2, child £1. Booking required, Tel. 01454 774479 www.winterbournebarn.org.uk

Sun 11th - Bingo Night, WADCA, Watleys End 7pm. Tel: 01454 776268 www.wadca.co.uk

Wed 14th - Carer's Club, Zion, 2-4pm. Carers welcome to stay with the person they care for or use the free time as they wish. More details from Jean 01454 775786 or Rona 01454 886925.

Thur 15th - Community World Dance, 2-4 pm, Zion Church Hall.

Fri 16th - Christmas Party & Meal, WADCA, Watleys End 7.30pm. £30/head. Tel: 01454 776268.

Fri 16th - Bingo Night, Crossbow, 8pm. All welcome. Tel. 772947 www.fcdca.co.uk

Wed 28th - Singalong Group, Zion, 2pm-3.30pm. For local people who enjoy a Singalong! Details from Jean 01454 775786 or Rona 01454 886925.

Sat 31st - New Year Party, WADCA, from 8pm. Tony Graham of "The Alligators" sings 50s, 60s, 70s hits and DJs your requests. £20 incl food. Adults only. www.wadca.co.uk

January 2017

Thur 5th - Community Singalong, Crossbow, 2-3.30pm. £3 includes tea and cakes.

Wed 11th - Carer's Club, Zion, 2-4pm. Carers welcome to stay with the person they care for or use the free time as they wish. More details from Jean 01454 775786 or Rona 01454 886925.

Thur 19th - Community World Dance, 2 - 4 pm, Zion Church Hall.

Wed 25th - Singalong Group, Zion, 2pm-3.30pm. For local people who enjoy a Singalong! Details from Jean 01454 775786 or Rona 01454 886925.

Thur 26th, Fri 27th & Sat 28th - "Pirates of the River Frome" Panto from St Peters Players, WADCA, Watleys End Road, 7.30pm (Two performances on Saturday with matinee at 2.30pm). Tickets £10 adult, £5 child.



A Bloomin Beautiful Day for Paul's Place

This year Paul's Place entered their community garden into BBC Points West Garden competition, we were pleased to receive the below account of the award ceremony by two members of Paul's Place for you to enjoy.



On 30th August, Joe, Annie, Joe and Kath travelled to Bowood House for the BBC Points West Garden Competition. We had teas and coffees first of all, whilst they explained what the day involved. We then went for a tour around the private walled garden, with our guide Mandy Dobson. We viewed a massive variety of different plants, our personal favourite was the Aztec Dahlias.

We then returned to the marquee, where we had sandwiches and a question and answer with Capability Brown at Bowood House and Matthew Pick head gardener from the prestigious gardens of Prior Park and they did the first 3 awards. Ours was the first award, unfortunately we were runners up in the Community Garden category, but they said it was a really hard decision.

We had to have an interval whilst Alex Lovell had to do her part for the BBC Points West introduction, then it went to live TV for the final award "Best Private Garden"

Afterwards we all had a chance to mingle with Alex, Lord Landsdown and the other competitors and had a group photo in front of Bowood House.

A great day had by all!

Joe & Annie (Paul's Place members)

News from Winterbourne Down W. I.

At our October meeting we were entertained by Sue Dugan who showed us how to decorate cup cakes, the theme being Hallowe'en. Members of our Committee made the cup cakes and Sue gave us bright green and orange icing and showed us how to make a witch with a black hat and a decorated pumpkin. We also made an owl and a bat. There was much amusement and chatter as the cake decoration progressed. All members went home with four decorated cakes.

This month is our AGM, followed by drinks and nibbles. On 1st December we have invited *Senior Moments* who host the game of *Call My Bluff*. They have been to us before and everyone enjoyed a fun evening.

Visitors are welcome to join us at 7.30pm in All Saints Church Hall.

Charity Dinner with Brian Moore

Whether you are an individual who loves Rugby, a group of people infatuated with the beautiful game, or perhaps you are part of a business that would like to treat its staff and/or colleagues to a great night, this should prove to be an awesome evening of entertainment!

The real kicker is that while you are having fun, you're also helping raise money for a very worthy cause!

First off, we have Brian Moore as our guest speaker! Brian ripped it up as an England hooker, he now commentates for T.V and radio, you might say he definitely has his own style? From Donald Trump, to Rugby, wine and just about any other topic, Brian has probably got something to say! Do you dare pit yourself against the 'Pitbull'? Could be entertaining?

Introducing SOS Kit Aid; this charity works with sports clubs around the world, it redistributes kits and equipment to clubs in the UK and abroad who are unable to afford the necessary gear needed to keep children safe and motivated while they partake in team sports. There is no doubt that club sports are of a real benefit to children, whether they are from under-privileged situations or not! We agree with SOS Kit Aid; sport gives kids community, belonging and discipline – help keep them safe, help keep them playing! Please visit www.soskitaid.com for more info.

We are offering a delicious 4 course meal, a charity auction and raffle, and of course a late license bar. The event is to be held on Friday 11/11/16 at North Bristol Rugby Club from 19.00 onwards, and all are welcome.

Please visit our website – www.jjsportscatering.co.uk/celebrity-charity-events for all info and prices and how to book your seat.

Please hurry as we have limited tables and spaces left available.



Come to Mortern Tavern on 26th / 27th November!

The young people of Your Call Theatre Group are proud to present *Mortern Tavern and Beyond*, a drama set in a dystopian future, where war is looming. No real battles have started yet, but blood has been shed and tensions are rising. What happens at Mortern Tavern, who will take up the gauntlet and where will their journey take them next?

This production is written, developed and directed entirely by the group, and is suitable for ages 12 plus.

Tickets are £5, to include refreshments. Saturday's performance is at 7.30 pm, and Sunday's at 2.30 pm, at Thornbury Methodist Hall, Castle Court. Call Jill on 01454 413850, or buy a ticket at the door.

Your Call Theatre Group is a Thornbury based drama club for young people aged 13 upwards. Their weekly sessions are held on a Friday evening (even during school holidays). They are led by stage-experienced people, often current members, and they love their past members – especially those now studying drama – to come back and share their learning and ideas with us. The group takes pride in its ethos of innovation, mutual support, fun and friendship, and enjoys trips to other productions, as well as putting on their own shows. Teenagers who are interested in drama and theatre are welcome, whether experienced or beginner. Call Jill on 01454 413850, or email us at yourcalldramagroup@live.co.uk.



Fromeside Gymnastics Club

- Pre School Classes for walking age - 4yrs - mornings & early afternoons Monday - Friday.
- Recreational classes for school age children 4 - 17yrs - weekday evenings & Saturday morning.
- Adult sessions 18+ Monday 9-10:30am
- Over 50's fitness group - Friday 10-11am

For full timetables check the website www.fromesidegym.co.uk
Contact us on: 01454 776873 Email: office@fromesidegym.co.uk

November at Winterbourne Library

Open: Tue and Fri: 9.30 am - 7.00 pm
Wed & Sat: 9.30 am - 5.00 pm
Closed: Mon, Thur and Sun

Rhymetime: Rhymes and songs for parents and babies/toddlers to enjoy together every Tuesday morning 9.30 – 10.00am

Pre School Storytime: Join us weekly on Wednesdays 9.30 – 10.00am for stories and crafts, term time only.

Chatterbooks group: for young people in Years 5 and 6 will be meeting on Saturday 5 November 2.30 - 3.30pm.

The Book Group for Parents will be meeting on Friday 11 November 2.00 – 3.00pm. New members are very welcome – please speak to a member of staff or contact the group's facilitator Liz on 07825510079.

The Craft Group is meeting on Saturday 5 and 19 November 10.00am – 12.00noon. New members are always very welcome.

IT Help! Our IT volunteer is here every Wednesday morning to help with all IT enquiries including getting online, setting up an iPad, basic computing skills, Universal Jobmatch, as well as help to download free ebooks and e-audio books from the LibrariesWest website. Just speak to a member of staff who will be happy to book you a free one hour session.

More great services: Other facilities at Winterbourne library include daily papers, laminating and fax services (charges apply), free internet access and free WiFi.

Staff will always be happy to make you a cup of tea or coffee for only 40p.

Did you know that you can reserve and renew books online? You can also download e-books, e-audiobooks and e-magazines. Find out all that's on offer on our website.

For more information: Tel: 01454 868006
Email: winterbourne.library@southglos.gov.uk
Website: www.southglos.gov.uk/libraries
Twitter: @southgloslibs 'Like' us on Facebook: **South Gloucestershire Libraries** for all the latest news.

Have Your Say!

Phase 2 of the consultation of the future of library services in South Gloucestershire:

Following the successful consultation process in the Spring, the council has adopted a new preferred position with the aim to future-proof South Gloucestershire's libraries for the long term and ensure that no library buildings should need to close. A new three month consultation is now running until January 2nd 2017 to hear what the public has to say about the new proposals and information is available online at www.southglos.gov.uk/librarychanges and in your local library and council offices.

The new preferred option is to reduce the library service savings target from £650,000 to £500,000. This would mean a smaller reduction in staff hours required to meet that target. The council will consult with library users and non-users alike on how best to deploy staff among local libraries. It is proposed that the mobile library service be replaced with community centre based libraries across South Gloucestershire and run by volunteer groups. The Council would also fund the building costs of Chipping Sodbury Library with the service being delivered by volunteers. These plans would mean that no library building would have to close as a result of the savings.

The council has also agreed to continue to develop plans to use technology that would allow registered members to use library facilities for 11 hours a-day, seven days a-week, between 8.30am and 7.30pm. This technological approach to delivering library services would build on existing self-service kiosks by providing access to library buildings for registered users out of staff hours, it would be a new approach for South Gloucestershire. The council wants to hear from existing library users as well as those who perhaps cannot currently use these facilities during current opening hours, about how they feel about this option.

After the new consultation process, a final decision on how to proceed will be made in the New Year. Changes in public-facing library services would not take place until October 2017.



Celebrating 200 years

The church at Whiteshill enjoyed three days of celebration over the August Bank Holiday weekend, marking its 200th anniversary.

A busy Saturday afternoon saw lots of visitors come to view the church decked out with floral decorations, see a local art exhibition and enjoy a display looking back over the chapel's history.

The Sunday of the holiday weekend was the exact date, two centuries ago, when the very first service was held in the chapel building. There was a big turn-out for a celebratory service, with visitors from further afield including the previous two ministers of the church and their wives.

During the service, the Bishop of Bristol – Rt Rev Mike Hill unveiled a commemorative plaque in the church foyer. Joined by the current and previous Whiteshill ministers, this short ceremony was relayed, live, back into the main church for the rest of the congregation to see.

Not far short of one hundred people stayed on for lunch in marquees on the church lawn and at 4pm there was a Songs of Praise service. This was rounded off by the ceremonial cutting of a 200th anniversary cake by current pastor David Horton and his wife Hazel. The cake was one of two, made especially for the occasion by a church member.

Festivities continued on Bank Holiday Monday, with a garden party in the church grounds. There were games for the youngsters, live music, cream teas – and importantly, glorious sunshine all day.

Some visitors took the opportunity to go on a conducted walk through Hambrook that linked local history with the early days and people of the chapel, while others inspected a display of old or unusual motorbikes.



Having this year undergone what is probably its most extensive renovation ever, the church also welcomed visitors on the South Gloucestershire Heritage Open Days this month, when those from beyond the immediate vicinity could take a look inside the newly-renovated Grade II listed building and learn something of its history.

Other events during the church's 200th anniversary, beyond its normal 11am and 6pm Sunday services, can be found on www.whiteshill.com.



News from the Friends of Brandy Bottom Colliery, Pucklechurch

The masons have completed rebuilding the tippler slots and the adjoining top of the north-west wall of the Old Pit heapstead. They have also finished repointing the outside of the octagonal section of the chimney and repositioned displaced

stones around the shoulder. We have started on planning for the next stage of conservation, which will cover work on the Horizontal Engine House and the walls of the New Pit heapstead. We have also had discussions with Ibstock Brick about extending the fencing to enclose the Fan Engine House, and about removing some trees along the cycle path to give passers-by a better view of the site. Spoil clearance in the Vertical Engine House restarted after the site clear-up.

During the course of a site visit in early July, Historic England informed us that they could not provide any more grants for conservation work. As a result we are in the process of finding alternative sources of funds. A photographer from Historic England came in mid-July to take a photo of the site for possible use in HE's 2016 Register of Heritage at Risk. We will only know if that is the case when the register is published in November.

The AIBT had a stand at the 2016 South Gloucestershire show adjacent to that of the South Gloucestershire Mines Research Group (SGMRG). Several visitors told us about playing in the buildings as kids, and one said that many objects had been thrown into the pond in the 1950s. Another talked about some of the people living in the cottages. We have invited these visitors to come to Brandy Bottom during a work party and point out features they remember. None of them appear to have photos from that date. Sadly Brandy Bottom appears several times in the new book1 published by the SGMRG on accidents, mainly fatalities, in

the area's coal mines. This is an update of the author's 1980s book, and the reports

give some idea of where the Brandy Bottom miners lived. Bearing in mind that the information comes from a small number of reports, we can say that Brandy Bottom's miners lived in Mangotsfield, Pucklechurch, Siston, and Soundwell.

They had a fair distance to walk to get to work, and get home afterwards in their grubby clothes. There were no such luxuries as pithead baths in those days.



North-west wall of Old pit heapstead from below, showing part of the brick pillar between the tippler slots balancing over the edge of the wall.



The same stretch of wall after rebuilding was completed, with the pillar between the tippler slots at the top of the photo.

Future Work Parties

At present access to the site is limited to days when there is a work party in progress. The dates for work parties for the remainder of 2016 are currently: Wed 09, Sat 19 November; and Sat 10 December.

Please note that these dates may be altered at short notice, so newcomers are advised to first make contact via the AIBT's email address of info@aibt.org.

There is now a location map on the website, currently accessible only from the 'Location and Public' Access' section of the main Brandy Bottom page. A description of how to get to the site from the car parking area, and links from other Brandy Bottom pages, will be added shortly.

To receive an e-mail with a detailed newsletter on all the recent activity that has taken place, please e-mail: info@aibt.org. or visit www.aibt.org

Photos thanks to © R Whitworth 2014-2016.



Two AIBT members and a visitor look at the Ram Hill display on the SGMRG stand

Retired Police Handyman Service

A network of trusted and reliable retired police officers who provide high quality handyman services to families, individuals and businesses in South Gloucestershire

CURTAINS, BLINDS, SHELVES, PICTURES, FLAT-PACK, PAINTING, DECORATING, WALLPAPER, DRIPPING TAPS, TILING, PLASTER REPAIR, KITCHEN FIT, LIGHT FITTINGS, GENERAL CARPENTRY, GUTTERS, DRAINS, LAWNS, HEDGES, FENCING, JET WASH & ALL OTHER ODD JOBS

SAVE 25% ON ALL WORKS FOR 12 MONTHS IF YOU REGISTER FOR FREE ONLINE OR BY CALLING 0800 255 0 255 BEFORE 31st January 2017 WHEN YOU QUOTE 'WF11'

No purchase necessary This cannot be used with a separate offer

0800 255 0 255
www.trustinblue.com

Trust in
Blue

Reliable Local Handymen

Retired police officers in South Gloucestershire are pioneers in an ambitious national network of highly vetted handymen launched by 'Trust in Blue'.

From building flat pack furniture to putting up shelves, decorating, basic plumbing, gardening and tiling, our local retired police officers with a passion for home maintenance will provide peace of mind to the residents and businesses of Winterbourne, Frampton and surrounding areas.

Typically police officers retire after 30 years service and a huge number are still eager to continue playing an active and productive role in their communities. All handymen prove themselves capable and experienced in home maintenance works before joining the network and carry recent CRB Checks.

Managing Director, Nick Orde-Powlett, hopes that the company's rigorous selection process will bring security and peace of mind to people in Gloucestershire:

"Our vetting process is second to none. All of our handymen are friendly retired police officers with many years working in the community under their belt – they understand people's concerns and fears better than anyone else and they genuinely care."

Handyman Jim Lias states: *"I have always had a keen interest in home maintenance and now I have the opportunity to spread the skills I have developed for the benefit of the local community"*

More information can be found on the website www.trustinblue.com and bookings can be made either by calling freephone 0800 255 0 255 or emailing helpdesk@trustinblue.com



A+ Appliance Repairs Free Call Out Today!

Cookers • Washing Machines • Dishwashers
Fridges • Freezers • Tumble Dryers • OAP Discount

01179 059 319
01454 660 064

8am-8pm 7 Days a week
Based in Bradley Stoke

From a single tile to a whole roof, all build and roof works undertaken, pitched and flat.



We have over 20 years experience are fully insured and all work is guaranteed.

For a FREE, no obligation quote and roof survey, just give us a call.

Office: **01454 615354** Mobiles: **Ben Peters: 07724 681620** or **Steve Coles: 07724 639830**
E-mail: roof-tech@hotmail.com

LOGS FOR SALE

100% Dry Seasoned Ash Logs

Large 1 tonne volume Builder's Bags or smaller net bags. Kindling also available.

FREE delivery Bradley Stoke, Winterbourne, Coalpit Heath, Frampton Cotterell, or collect from Viaduct Nursery Flower Shop.

Call 07538 540171



Clover Ovenclean will clean your oven, range, hob, extractor or Aga using a non-caustic, fume free, eco-friendly system

Call Heath on 07943 870400
www.cloverovenclean.co.uk

Professional Oven Cleaning Services

BonneFreshClean
Carpet & Upholstery Cleaning Specialists

NCCA
MEMBER 2011

Professional carpet, upholstery and leather cleaning carried out with care by an all-female team

For a free no obligation quotation call Karen on
01454 436001 or 07774 908410
www.bonnefreshclean.co.uk
44 Townsend Lane, Almondsbury, Bristol, BS32 4EQ

J G Carpentry

- Extensions
- Renovations
- Kitchens
- Bathrooms
- Staircases
- Exteriors



For a professional service and a competitive quote contact Jim:
01454 851032 or 07738934875
www.jgcarpentry.com

THE AERIAL MAN
(DAN GRACE)
Local engineer

Which?
Trusted trader

- Digital Aerials
- Fully Guaranteed
- Repairs
- Sky Work
- Free Quotes
- OAP Discounts
- Poor Reception Problems
- Additional TV Points

01454 660 046 | 07818 413 451
www.theaerialman.co.uk

Avanti Cars



- 4 & 6 seater vehicles
- Evenings out
- Local & long distance
- Lady driver available
- Airport & seaport transfers
- Friendly reliable service
- Weddings/special occasions
- Credit & Debit Cards

Tel: 0117 931 1473 Mobile: 07973 705522
www.avanticars.org.uk Bakers Ground, Stoke Gifford

GAS HEATING AND PLUMBING PROBLEMS

Resolved inexpensively by friendly local Gas Safe engineer

All work fully guaranteed - No VAT - No callout charge

Landlords Certificates - Boiler Replacements - Servicing

All makes and models - Cookers - Fires - Weekends / Evenings

Peter Ryecroft 01454 250530 / 07968 281317
Visit Owl's Website at www.atpitch.com



OVENCLEAN
The original oven cleaning specialists

Ovenclean will transform your oven and put the sparkle back into your kitchen!

Local, friendly, professional, reliable
Eco-friendly cleaning, no fumes, no mess

Call Myles on
07557 110932 or 0117 969 5228
www.ovenclean.com

SWORD HOME IMPROVEMENTS

- Plastering
- General Building
- Property Maintenance
- Kitchen and Bathroom Installations

For a local reliable service
Call Mark on 01454 856554 0771 7863127
Email: msword67@live.co.uk

GARY SMART ELECTRICAL

Domestic & Commercial Installations

All electrical work undertaken

- Rewiring
- Lighting
- Bathroom Showers
- Kitchens
- Garden & Garages
- Safety inspections
- Periodic testing
- Fault finding and Repairs.

Based locally in Downend

Fully qualified City & Guilds Electrician
17th Edition Part P registered.

Mobile: 07805 070 947
Home: 01179 871 437



All backed with a 6 year Niceic insurance policy

Arby's
Home gardening

Professional and reliable garden care.
One-off visits or regular garden maintenance.

Our Services Include:

- Garden Clearance
- Lawn Maintenance
- Hedge Trimming
- Patio Cleaning
- Weeding / Planting
- General Maintenance

Please contact Richard on:
01454 886537 / 07779874439
enquiries@arbysgardening.co.uk

BEAUFORT
PROPERTY MAINTENANCE

PAINTING & DECORATING
HOME IMPROVEMENT
MAINTENANCE & REPAIRS



- PAINTING & DECORATING
- BUILDING MAINTENANCE & REPAIRS
- KITCHENS
- TILING
- ROOF REPAIRS
- FASCIA & GUTTERING

FREE QUOTATION
No Obligation

Call today to see how we can help on **01454 777 887 or 07980 301 905**
Email: info@beaufort.uk.com



For complete reassurance ask to see our customer service charter.

At Capricorn Plumbing, our qualified plumbers apply the same high standards of quality, integrity, tidiness and politeness in everything they do. And you can be sure of a fair price too. But don't take our word for it – call us for a free, no obligation quote today!

You're in safe hands for...

- complete bathroom makeovers, including design, tiling and electrics
- boiler installations, servicing and landlord certification
- plumbing, gas and oil repairs and installations throughout your home
- a fast emergency call out service with no call out charge

t: 01454 270179 m: 07971 602826

73 Northover Road, Westbury on Trym, Bristol BS9 3LQ • www.capricornplumbing.co.uk

Registered Office: Woodlands Grange, Woodlands Lane, Bradley Stoke, Bristol BS32 4JY



Rubber Flat Roofing
Pitch Roofing • Sun Tiles
u.P.V.C. Cladding & Guttering
Velux Windows • Lead Work
All Remedial Work

**ALL WORK
GUARANTEED**

TEL: 01454 250148
MOBILE: 07831 616184
www.coverallroofing.co.uk

CWG DESIGN & BUILD LTD

Local reputable building contractors with over 30 years' experience – refs available upon request

New builds with NHBC warranty, extensions, loft conversions, annexes, renovations, roofing, registered installer of "CrysticROOF" GRP System (Glass Reinforced Polyester Roofing System), and lots more



Tel: 07980 858249, 01454 501104,
email: cwg@talktalk.net

ELITE HYGIENE SERVICES DEEP CLEANING SPECIALIST!

- Kitchens • Washroom & Toilet Descaling
- Carpets • Upholstery
- Fire & Flood Damage
- Patio & Gutter Cleaning
- Painting & Decorating
- EMERGENCY DRAIN CLEANING SERVICE

CALL (01454) 777826
MOBILE (07850) 873067



**ALL WORKS
BRISTOL LTD
PLUMBING
& HEATING**



**ALL WORKS
BRISTOL LTD
BATHROOM
INSTALLATIONS**

- Gas Safe Registered
- Specialist Boiler Servicing, Repair and Installations
- Up to 10 year warranty on new Worcester boiler installations
- Accredited installers for Worcester and Vaillant

- Professional, fully qualified and experienced
- Complete Bathroom Installation
- Bathrooms
- Wet Rooms
- All Plumbing Works
- Tiling and Flooring

www.allworksplumbingandheating.co.uk
www.allworksbristoltd.co.uk

Enquiries **01454 279162**



C.J.P Landscaping



& Tree Maintenance

NCH Arboriculture
Qualified Bricklayer
Full Public Liability Insurance
Micro Digger and Chipper Facility

Specialist in:

- Hedge Trimming
- Tree Work
- Stump Grinding
- Drives, Patios, Decking
- Fencing
- Raised Sleeper Beds.

All types of
Landscaping and
Drainage
Undertaken.

Contact us on: Mobile - 07879845051 Landline – 01454 528 744
Email - parsons.com@hotmail.com Also find us on Facebook for our full portfolio



HOME CARE
Plumbing & Heating Ltd
Est. 2002

We are a small, family owned and run firm covering all aspects of domestic plumbing and heating services

- As Featured on DIY SOS -

Worcester Bosch and Vaillant accredited,
Competitive Rates
OFTEC and GAS SAFE Registered
All general plumbing and heating work undertaken

01454 414438
01275 861010 / 0117 3035179

email: elizabeth.arndell987@btinternet.com
www.homecare-plumbing.co.uk



DG PROPERTY MAINTENANCE
• KITCHENS • BATHROOMS • CARPENTRY
• PAINTING & DECORATING • PATIOS
All Property Maintenance Undertaken
No Job Too Small
For a no-obligation Quote
Please Call Dean on: Day: 079466 82167
Evenings: 01454 600699
Local Reliable Service ~ References available

A.1. AERIALS

- Digital TV Aerials
- Sky Digital / Freesat / FreeviewPay
- Repairs
- Extra TV Points
- Phone now for Free Quotation

07956 491495 / 01454 318873
www.A1aerialsbristol.co.uk



ACE TAXIS
Covering Winterbourne, Frampton Cotterell, Coalpit Heath & surrounds

SHORT & LONG JOURNEYS
STATION & AIRPORT BOOKINGS



ALL MAJOR DEBIT & CREDIT CARDS ACCEPTED

TEL: 01454 626 837 / 07971 775 615

FRAMPTON TAXIS
ALL UK AIRPORTS. PORTS & STATIONS COVERED
4, 5 & 6 SEATERS AVAILABLE
Lady driver available on request. 
For a Friendly Prompt Service call or E-Mail:
07960 067767 - 01454 279517
E: framptontaxis@tiscali.co.uk
www.framptontaxis.co.uk



Jon Drake
Plastering Service

A quality and reliable local plasterer for internal and external work.

- Skimming
- Dry Lining
- Artex plastered over
- Rendering
- Fully Insured



Please ring Jon for a free quote with no obligation

Tel 0117 979 0575
or **07800 939 148**
www.jondrakeplastering.co.uk

Liza and Sharon
Domestic Cleaning Services



- Weekly & Fortnightly Cleans
- Spring Cleans
- Fully Insured Operatives

Tel: 01454 777 248
Mob: 07971 013 914

D-CR DOMESTIC APPLIANCES
DOMESTIC APPLIANCE SALES AND REPAIRS

Washing Machine • Fridge Freezer
Tumble Dryer • Cooker
Dishwasher • Hob or Hood

Tel 01454 850522 or 07917441539
EMAIL: d-cr@live.co.uk
www.d-crdomesticappliances.co.uk



P.M. Autos
Unit 2 kendleshire Farm, Down Road, Winterbourne Down Bristol BS36 1AU

- Car & Van servicing & repairs
- Tyres
- Brakes
- Exhausts
- Air Conditioning
- Clutch & Cam Belt Replacement
- MOT
- Repairs
- Welding

Telephone: 01454 775757 Mobile: 07831 33 11 57

Garage Doors
Installation | Maintenance | Repairs
Your local independent garage door specialists

Up & Over Doors | Sectional Doors | Roller Doors



VARIETY OF STYLES TO SUIT YOUR REQUIREMENTS

Call Brunel doors for your free no obligation quotation
BRUNEL DOORS
01454 882212
Visit our website: www.bruneldoors.co.uk

Frampton Garage
(SOUTH GLOS LTD)



MOT's only
£34.95

Like us on Facebook for special offers

- MOT's
- Servicing
- Repairs
- Clutches
- Brakes
- Diagnostics
- Electrical Repairs
- Air Conditioning
- MOT & Interim Service from * £99 *(T&C apply)

Tel: 01454 777841 01454 777607
M: 07879 477713
www.framptongarage.com
Open Mon-Fri 8am - 6pm Sat 8am - 1pm
Family based business
76, Woodend Road, Frampton Cotterell



'Jill Of All Trades'

A reliable female who can add a woman's touch to a professional service

- Painting & decorating
- Home maintenance
- Curtain making

With several years' experience in the above, I'm willing to take on jobs ranging from a ceiling needing a coat of paint, to odd jobs that need finishing around the house, to a complete room makeover. I can also offer advice on colour schemes and decor to co-ordinate with existing furnishings.

I'm happy to do the jobs larger companies aren't prepared to do!!

Call Alex

on 01454 886537 or 07919 554658

Email: alexcrice@hotmail.com

LOW COST PLUMBING



- Taps, Washers ✓
- Toilets, Cisterns ✓
- Leaks, Blockages ✓
- Tanks, Overflows ✓
- Lead Pipes, Stopcocks...etc... ✓

OAP DISCOUNTS and NO VAT

0117 957 5092

South Gloss Decorating

Painters & Decorators

Interior and Exterior

Affordable, Reliable, Professional

Dave Beauchamp

0117 956 9932

07739 382 524

davebeauchamp@msn.com

www.facebook.com/southgloss



John Harris
30 Quarry Barton
Hambrook
Bristol. BS16 1SG

**QUARRY
GARDENS LTD**

**STONE MASONS ~ LANDSCAPING
GENERAL BUILDERS**

Tel: 01454 772 502 Mob: 07919912966

MD Aerials
Call Michael Dagger

Freeview – Freesat – Sky – DAB Aerials

Wall mounting LCD or Plasma
televisions – setting up & tuning

mike@mdaerials.co.uk
www.mdaerials.co.uk

T: 01454 418 341 - M: 07817 304 236

Millard Electrical Services

- Additional lighting & Power • Showers.
- Kitchen Upgrades • Fuseboard Replacements
- Outdoor power • Complete rewires • Fault finding
- Testing • Landlord certificates

Please contact Tom for a free quotation on:
Tel: 01454 603687 Mobile: 07828 555925
Email: tmillard-mes@hotmail.co.uk

APS Landscaping & Groundworks

Equine & Agricultural

M: 07973 101720

Fax 01454 776789

- Mini Auger-for post hole drilling
- Hydraulic Breaker-for concrete breaking
- Mini Mower-for hard to reach places
- Micro Digger for 2'6" access points
- Bramble / Hedge trimming • Fencing & Gates
- Concreting • Footings • Ditches / Drain work
- All weather surfaces • Riding arenas
- Ponds & Lakes • Paddock care • JCB Work



Adrian Sarkar

CPCS Registered Operator

E: adriansarkar@googlemail.com

Based in Frampton Cotterell



LJP Construction

Quality building work at competitive prices

We offer a range of services to suit every budget:

- Extensions
- Renovations
- Conversions
- Roofing
- Driveways
- Patios

Our aim is to provide every customer with an Assured, Affordable, Professional Quality Service from start to finish.

Please contact Lewis for a free quotation on:

01454 853975 / 07837 065 902

Email: ljp.construction@hotmail.com

www.ljpconstruction.co.uk

Based in Frampton Cotterell

MT Garden Solutions
For all your gardening needs

- Grass Cutting
- Hedge Trimming
- Garden Maintenance
- Fencing
- Decking & Patios

Contact Mark on: 0771 4255392

www.mtgardensolutions.co.uk

Emergency number: 07798 905 337
Keep it in your mobile

Lock Stuck and Barrels
The complete door and window service

Locked out?
Need to replace or change your locks?

- Swift LOW cost emergency service to all home/commercial lock outs.
- Non destructive methods gaining entry quickly and efficiently from the initial call.
- Keys or handbag stolen? Burgled! Need your locks changed or re keying on a new home, call us.

ALSO: LOW cost Repair / replacement of UPVC / ALUMINIUM WINDOW and DOOR: LOCKS, HINGES, HANDLES and MISTED UP / BROKEN DOWN DOUBLE GLAZED UNITS.

Full explanation and costs given before any works carried out. All work fully guaranteed. No call out fee

Call Dave on 07798 905 337

www.thebristollocks.co.uk
Based in Frampton Cotterell

A K PLUMBING

Dripping tap? Burst pipe? Toilet won't flush?

From full bathroom suites to outside taps and everything in between

We carry out all plumbing maintenance and repairs

24-Hour Emergency call out 0774 775 0136

Give us a call: 01454 600375

www.akplumb.co.uk

Covering Winterbourne, Frampton and surrounds



The annual Santas on the Run 2k fun run is back in Bristol on Sunday 11 December 2016.

Grab your family, friends and colleagues (and dog!) and take part

in this extraordinary dash across the city dressed as Santa and raise vital funds for local charity, Children's Hospice South West (CHSW).

Last year over 2,000 people descended upon Bristol's Harbourside dressed in their complimentary Santa suits to dance/walk/jog/skip their way round the city. The event was a huge success and raised over £53,000 in sponsorship for CHSW's Charlton Farm hospice, which supports approximately 200 families who have children with life-limiting or life-threatening conditions as well as over 55 bereaved families. Registration for Santas on the Run is £15.00 per adult, £7.50 per child or £37.50 for a family ticket and £135 for a team of 10 adults. Entry includes your Santa suit, medal and festive treats!

Sign up at www.chsw.org.uk/santasbristol

Inspired Bathrooms

Design & Installation

- Bathrooms
- Wetrooms
- Tiling
- General Plumbing
- Workmanship guaranteed
- Portfolio and references available on request

Call us on

01173 307 537 or 07853 069 280

www.inspiredbathrooms.net

inspiredbathrooms@hotmail.co.uk

Inspired by you, designed & installed by us



• Glass Cut While You Wait

• UPVC - Repair Work on Misted Units

Windows / Locks / Mechanisms and Hinges

• Replacement - PVCu Windows & Composite

Doors, 10 year guarantee on parts and labour

• Mirror Showroom - Mirrors cut to size

• Glass Splashbacks any shape, colour or size

FENSA REGISTERED

Tel: **0117 9693778 / 9793980**

Email: sales@jbglazing.net

www.jbglazing.co.uk

10% OFF with this advert

quote WMJB upon enquiry
T&C apply see in store for details

367 Filton Avenue Horfield, Bristol BS7 0BD



A E Rollin & Sons Ltd.



Family run Builders & Roofing Contractors, Established 1959

Extensions : Renovations : Conversions : Refurbishments

Brick & Stone work : Carpentry : Roofing : Patios & Paving : Fascias & Soffits

49, Nicholls Lane, Winterbourne, Bristol. Tel 01454 773684

email : aerollinandsons@hotmail.co.uk

Ashford BUILDING CONTRACTORS

Design & Build - Extensions
Renovations - Kitchens
Plastering - Roofing

Call for a free no obligation quote
01454 610256 / 07974 199 680
AshfordBuilding@aol.com
www.AshfordBuilding.com



'All Angles Covered' Plastering Services

All aspects of plastering work undertaken

Neil Gaynor
Tel: **01454 613441**
Mobile: **07779 588541**
E: neilgaynor@allanglescovered.co.uk
Reliable, competitive and professional

1st Call

- Lock Opening
- Garage Security Locks
- High Security Padlocks
- Digital Locks
- Locks for uPVC Doors & Windows



Local Mobile Locksmith

MLA Approved Locksmith Company Providing Fast, Personal Service at competitive Rates



Carl Jenkins MIMLA MBMI
Locksmith Engineer



0117 957 0011
E: info@keymasterbristol.com

W.J.M Plumbing & Tiling

OAP DISCOUNT

FULLY QUALIFIED
Ciphe Member

24 hour call out - No Job Too Small

Bathrooms ~ Kitchens

Unblocking Drains ~ Leaks Repaired

Reliable, Affordable

Friendly Service.

TEL: **01454 851830**

MOB: **07902 383219**



Based in Coalpit Heath

R & B ROOFING

DOMESTIC & INDUSTRIAL ROOFING

• Flat Roofs • UPVC Fascias & Cladding

• Steel Sheeting & Cladding

Members NFRC No 5042

Tel: **01454 250 144**

Mobile: **07768 357 040**



• PVCu Fascia Boards
• GUTTERING
• SOFFITS
• CLADDING

FASCIA lift

01454 269011
07813 006950
matt@fasciabristol.co.uk
www.fasciabristol.co.uk

Index of Local Advertisers

Aerials		Computer services:		Painter / Decorator / Tiler -	
A1 Aerials	40	IT - Repair/help-		Jill of All Trades	42
Dan Grace Aerials	37	Frampton Cotterell Computer group	6	Beaufort Property Maintenance	37
M D Aerials	42	Winterbourne Computer services	20	South Gloss decorator	42
Antenatal Courses		Electrician		Pet Care / Cremation -	
New Life Classes	4	Millard Electrical services	42	Bubbles dogwash	18
Architect		Gary Smart	36	Companions Haven pet cremation	19
Alex Cork	23	Electrical Appliance Repairs		Susan's Pets	18
Bathrooms / Fitting		A+ Electrical Repairs	35	Plasterer -	
All Works	39	DC-R domestic appliance repairs	40	All Angles	45
Inspired Bathrooms	44	Estate Agents/Property Letting		Jon Drake	40
Bicycle Repair		AJ Homes	1	Plumbing/heating engineers	
Rule 4 Cycles	8	Bundy and Bond Estate Agents	3	All works plumbing/Heating/Bathrooms	39
Blinds/Curtains		Mackendrick Norcott	1	AK Plumbing	43
Curtain company	39	Farm Shop/Cafe		Capricorn Plumbing	38
Builders/Groundwork/property svcs		Poplars Farm	23	Home Care Plumbing	40
A E Rollin Builder	44	Food & Drink		Low Cost Plumbing	42
APS Groundwork	43	Smokehouse at the Swan	13	Peter Rycroft Plumbing/Heating	36
Ashford Building Ltd	45	Gardens / Garden Maintenance		WJM Plumbing/Tiling	45
Beaufort Property Maintenance	37	Arby's Garden Svcs	36	Roofing	
CWG Design & Build Limited	38	CJP Landscapes	39	Coverall Roofing	38
DG Property Maintenance	40	MT Garden solutions	43	R&B Roofing	45
LJP Construction	43	Quarry Garden	42	Rooftech	35
Cakes/cooking -		Glazing -		Schooling/Tuition -	
Medway Designs	20	J B Glass and Glazing	44	Coalpit Heath pre-school	4
Carpet & Upholstery Cleaners		Hair / Beauty/Massage -		Oscars pre school/Holiday club	16
Bonne Fresh Clean	36	Beauty Plus	11	SGS College	2
Car / Motorbike- Repair/Valet/MOT		Handyman / various skills offered		Winterbourne Early Years	17
Frampton Garage	41	Jill of All Trades	42	WizKidz	16
P M Autos	41	Trust in Blue	34,35	Sewing Alterations	
Carpenter -		Home Improvements -		Medway Designs	20
J G Carpentry	36	Fascialift	45	Slimming Clubs	
Child Activities / Care		Southern Plasticad	48	Slimming World	27
Coalpit Heath pre-school	4	Sword Home Improvements	37	Social/Community & Clubs-	
Fromeside Gym Club	30	Hotel/Conference/Weddings		Fromeside Gym Club	30
Oscars pre school/Holiday club	16	Holiday Inn	47	Stairlifts	
Winterbourne Early Years	17	Mecure	10	Thornbury stairlifts	7
Wiz Kidz	16	Insurance -		Taxi Service -	
Cleaning & Domestic Services		AgeUK concern	6	Ace Taxi	41
Clover Oven Clean	35	Locksmith -		Avanti Cars	37
Elite Hygiene Services	38	Keymaster	45	Frampton Taxis	41
Liza & Sharon Domestic Cleaner	40	Lock Stuck and Barrels	43	Windows/Conservatories & Doors -	
Oven Clean	37	Logs for sale		Brunel Garage doors sales/repair	41
Complementary / Holistic Therapies		Opticians -		Southern Plasticad	48
Catherine Smart Hypnotherapy	8	Mike Harbord Opticians	26		
Osteomyologist - Dawn Clode	9	Spec Savers	9		

EDITOR'S NOTE: Winterbourne and Frampton Matters is independently published and delivered FREE to every home (c 7,000+) in Winterbourne, Frampton, Coalpitheath, Winterbourne Down and Moored. The views and opinions expressed are not necessarily those of the editors (unless it is a personal review of a service that we have participated in). We cannot vouch for every advertiser personally (although since starting in April 2009 we have used many of the services ourselves). Any feedback or experience is welcomed. We would like to thank all the advertisers who support this publication and therefore make it possible. Please return their support by utilising their services when and where you can. It is the advertiser's responsibility to ensure conformity with the Trade Descriptions Act 1975, Business, Advertisements Disclosure Order 1977, Sex Discriminations Act 1975 and the Consumer Credit Act 1974. We cannot be held responsible for misrepresentations in the adverts included. All artwork created by Matters Magazines must not be published in any other media without our permission. © Matters Magazines 2015 © Winterbourne & Frampton Matters 2015.

If your group, organisation or business would benefit from appearing in this magazine please call Jaci on 01454 300 900.

CHRISTMAS PARTY SEEKERS

Welcome



PARTY NIGHTS

Candy Land Christmas Party Nights

Get into the Christmas spirit with one of our Candy Land themed party nights.

There will also be a sweet treat gift for everyone.

Mid-Week Christmas Party Nights

We promise you a fun-filled evening with great food and great music whilst enjoying excellent mid-week savings.

Price for all nights includes:
- Half bottle of wine per person
- Crackers and novelties
- Disco until 1am
- Access to our 'belle station' where we provide the props and you provide the camera!

Private Hire available.

Held in the Sequoia Suite or Junction Restaurant.



TRIBUTE NIGHTS

Held in the Sequoia Suite, our popular tribute nights are always a success.

Join us this year for our Ultimate Boyband act including hits from Take That, Backstreet Boys, The Westlife and Blue plus many more.

Alternatively, enjoy being serenaded by the new and only Michael Bialle tribute.

Murder Mystery Night

Step in to a world of intrigue and mystery and join us to solve the murder! Price includes murder mystery act.

Held in the Sequoia Suite or Junction Restaurant.

Price for all nights includes:
- Half bottle of wine per person
- Crackers and Novelties
- Disco until 1am

Candy Land Party Nights

Adult: £42.95 per person

Dates: 25th and 26th November, 2nd, 3rd, 6th, 10th, 18th and 17th December

1 drink and 1 glass

Mid-Week Party Nights

Adult: £29.95 per person

Dates: 1st, 4th-8th, 11th-13th and 18th-22nd December

1 drink and 1 glass

Tribute Nights

Adult: £42.95 per person

Dates: Thursday 1st December (Ultimate Boyband), Thursday 8th December (Michael Bialle)

1 drink and 1 glass

Murder Mystery Night

Adult: £42.95 per person

Date: Saturday 28th November

1 drink and 1 glass

To book call us now on 0117 910 4253 or email meetings-bristol@hibristolfilton.co.uk

W: hibristolfiltonhotel.co.uk | [HIBristolFilton](#) | [HolidayInnBristolFilton](#)
Terms and conditions apply.



Holiday Inn
BristolFilton

Southern Plasticlad Ltd.

WINDOWS, FASCIAS, CONSERVATORIES AND ROOFS

Conservatories to your
Individual tastes and budget
Georgian · Victorian · Lean-to
OR

ALL NEW **GUARDIAN** warm roof system



Guardian
Warm Roof

Flat Roof Problems?

RUBBERBOND
FLEECERACK
EPDM



We specialise in
all types of roofing
including pitched
roofing.

We can offer a
number of different
styles of roof
tile or simply
replace the
existing tiles



PVCu Solid · Replacement Fascias
Soil Stacks and Cladding
Guttering · Soffits
Choice Of Colours · Range of Styles

FENSA

Registered Company 30873



Approved by BBA

Composite Doors
Available in a variety of colours
and Designs
Giving the appearance of a solid door

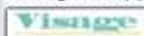

Double glazed windows and Doors
upto A+9 Rated
Contemporary or Traditional
Choice of colours · Range of Styles

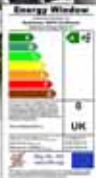

VISIT US TODAY FOR A GREAT BARGAIN!

sales@southernplasticlad.co.uk
www.southernplasticlad.co.uk

SHOWROOM OPEN
MON-FRI 9am-5pm SAT 9am-12pm

Unit 4 Ram Hill Business Park
Ram Hill, Coalpit Heath BS37 2TX

Freephone 0800 542 6066

Telephone 01454 777 732